

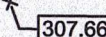

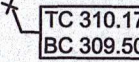

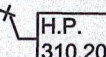



LEGEND

	PROPOSED MAJOR CONTOUR
	PROPOSED MINOR CONTOUR
	PROPOSED SPOT ELEVATION: TOP OF CURB BOTTOM OF CURB
	PROPOSED SPOT ELEVATION: HIGH POINT
	PROPOSED SLOPE ARROW
	PROPOSED STORM LINE
	PROPOSED STORM MANHOLE
	PROPOSED STORM INLET
	PROPOSED ROAD DRAIN
	PROPOSED CLEANOUT
	CLAY CORE
	BASIN SEED MIXTURE

1. THE CONTRACTOR SHALL PRESERVE EXISTING VEGETATION WHERE POSSIBLE AND/OR AS NOTED ON DRAWINGS. REFER TO SEDIMENT AND EROSION CONTROL PLAN FOR LIMIT OF DISTURBANCE AND EROSION CONTROL NOTES.
2. TOPSOIL SHALL BE STRIPPED AND STOCKPILED ON SITE FOR USE IN FINAL LANDSCAPING.
3. THE CONTRACTOR SHALL COMPACT FILL IN LIFT THICKNESS PER THE GEOTECHNICAL REPORT UNDER ALL PARKING, BUILDING, DRIVE AND STRUCTURE AREAS TO 95% OF THE MAXIMUM DRY DENSITY (AS DETERMINED BY ASTM D1557 (MODIFIED PROCTOR TEST), OR AS REQUIRED BY THE GEOTECHNICAL ENGINEER.
4. UNDERDRAINS SHALL BE ADDED, IF DETERMINED NECESSARY IN THE FIELD BY THE OWNER/GEOTECHNICAL ENGINEER, AFTER SUBGRADE IS ROUGH GRADED.
5. UTILITY CONNECTION DESIGN AS REFLECTED ON THE PLAN MAY CHANGE SUBJECT TO UTILITY PROVIDER AND GOVERNING AUTHORITY STATE REVIEW.
6. THE CONTRACTOR SHALL ARRANGE FOR AND COORDINATE WITH THE RESPECTIVE UTILITY PROVIDERS FOR SERVICE INSTALLATIONS AND CONNECTIONS. THE CONTRACTOR SHALL COORDINATE WORK TO BE PERFORMED BY THE VARIOUS UTILITY PROVIDERS AND SHALL PAY ALL FEES FOR CONNECTIONS, DISCONNECTIONS, RELOCATIONS, AND REMOVAL AND DEMOLITION UNLESS OTHERWISE STATED IN THE PROJECT SPECIFICATIONS MANUAL AND/OR GENERAL CONDITIONS OF THE CONTRACT.
7. ALL PIPES SHALL BE LAID ON STRAIGHT ALIGNMENTS AND EVEN GRASSES USING A PIPE LAYER OR OTHER ACCEPTED METHOD.
8. THE CONTRACTOR SHALL COMPACT THE PIPE BACKFILL IN 8" LIFTS ACCORDING TO THE PIPE BEDDING DETAILS. TRENCH BOTTOM SHALL BE STABLE IN HIGH GROUNDWATER AREAS. A PIPE FOUNDATION SHALL BE USED PER THE TRENCH DETAILS AND IN AREAS OF ROCK EXPOSURE.
9. CONTRACTOR TO PROVIDE STEEL SLEEVES AND ANNULAR SPACE SAND FOR UTILITY PIPE AND CONDUIT CONNECTIONS UNDER FOOTINGS.
10. BUILDING UTILITY PENETRATIONS AND LOCATIONS ARE SHOWN FOR THE CONTRACTOR'S INFORMATION AND SHALL BE VERIFIED WITH THE BUILDING MEP, STRUCTURAL, AND ARCHITECTURAL DRAWINGS AND WITH THE OWNER'S CONSTRUCTION MANAGER.
11. A ONE-FOOT MINIMUM VERTICAL CLEARANCE BETWEEN WATER, GAS, ELECTRICAL, AND TELEPHONE LINES AND STORM PIPING SHALL BE PROVIDED. A SIX-INCH MINIMUM CLEARANCE SHALL BE MAINTAINED BETWEEN STORM PIPING AND A SANITARY SEWER WITH A CONCRETE ENCASEMENT. AN 18-INCH TO 6-INCH VERTICAL CLEARANCE BETWEEN SANITARY SEWER PIPING AND STORM PIPING SHALL REQUIRE CONCRETE ENCASEMENT OF THE PROPOSED PIPING.
12. SITE CONTRACTOR SHALL PROVIDE ALL BENDS, FITTINGS, ADAPTERS, ETC., AS REQUIRED FOR PIPE CONNECTIONS TO BUILDING STUB OUTS, INCLUDING ROOF/FOOTING DRAIN CONNECTIONS TO ROOF LEADERS AND TO STORM DRAINAGE SYSTEM.
13. PIPING SHALL BE LAID FROM DOWNGRADE/END OF PIPE RUN IN AN UPWARD DIRECTION WITH BELL END FACING UPWARD IN THE DIRECTION OF PIPE LAYING.

[illegible]

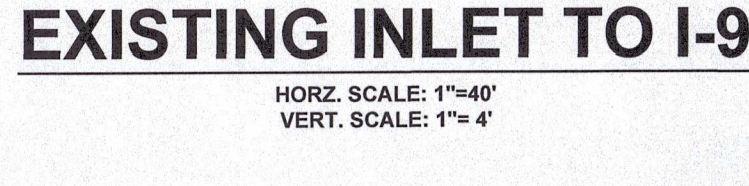
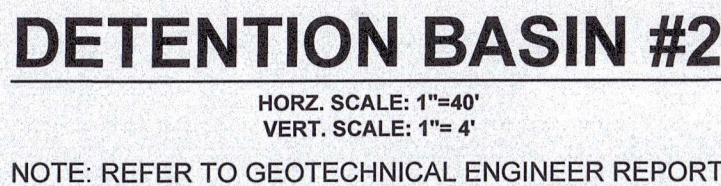
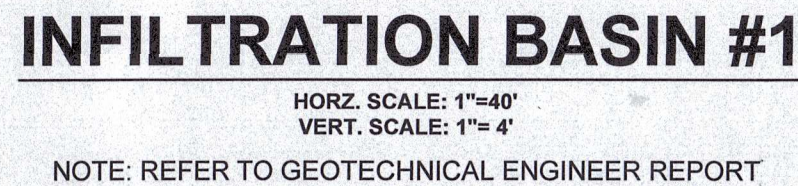

1. THE PURPOSE OF THESE INSTRUCTIONS IS TO IDENTIFY THE OWNERSHIP AND MAINTENANCE ACTIVITIES ASSOCIATED WITH THE PROPOSED RAINGARDEN. THE AFOREMENTIONED FACILITIES SHALL BE THE RESPONSIBILITY OF THE PERMIT APPLICANT (PERMITEE).
2. ALL PCSM BMPS WILL BE INSPECTED ACCORDING TO THE SCHEDULES LISTED BELOW. A WRITTEN REPORT MUST BE COMPLETED DOCUMENTING EACH INSPECTION AND ANY REPAIR, REPLACEMENT OR MAINTENANCE ACTIVITY.
3. SOIL, TRASH, DEBRIS OR OTHER MATERIALS REMOVED FROM PCSM BMPS SHALL BE REMOVED FROM THE SITE AND RECYCLED OR DISPOSED OF IN ACCORDANCE WITH THE DEPARTMENT'S SOLID WASTE MANAGEMENT REGULATIONS AT 25 PA. CODE 260.1 ET SEQ. 271.1, AND 287.1 ET SEQ. NO WASTES, UNUSED BUILDING MATERIALS OR OTHER MATERIALS SHALL BE BURNED, BURIED, DUMPED, OR DISCHARGED AT THE SITE.
4. ALL DAMAGED OR NON-FUNCTIONAL BMPS SHALL BE REPAIRED IMMEDIATELY. ANY PCSM BMPS THAT CANNOT BE REPAIRED MUST BE REPLACED AS SOON AS PRACTICABLE.
5. THE PERMIT APPLICANT SHALL BE RESPONSIBLE FOR THE MAINTENANCE OF PERMANENT STORMWATER FACILITIES LOCATED ON THE SUBJECT PROPERTIES. PERMANENT MAINTENANCE OF THE STORM SYSTEM AFTER ACCEPTANCE WILL PRIMARILY CONSIST OF ROUTINE CLEANING OF ACCUMULATED SEDIMENT AND DEBRIS BY FACILITY STAFF OR PRIVATE CONTRACTORS. THE SPECIFIC MAINTENANCE STEPS AND SCHEDULE ARE LISTED BELOW:
6. AT A MINIMUM, ALL BEST MANAGEMENT PRACTICES (BMPs) SHALL BE INSPECTED BY THE LAND OWNER/DEVELOPER OR RESPONSIBLE ENTITY ANNUALLY FOR THE FIRST YEARS, ONCE EVERY 3 YEARS THEREAFTER, AND DURING OR IMMEDIATELY AFTER THE CESSATION OF A 100-YEAR OR GREATER STORM EVENT.

<h1>DRY EXTENDED DETENTION BASIN</h1>	
<h2>OPERATION & MAINTENANCE PROCEDURES</h2>	
ACTIVITY	SCHEDULE
REPAIR UNDERCUT OR ERODED AREAS, MOW SIDE SLOPES, SEED OR SOD TO REPAIR DEAD OR DAMAGED GROUND COVER.	AS NEEDED
ALL BASIN STRUCTURES EXPECTED TO RECEIVE 40% OR TRAP DEBRIS & SEDIMENT SHOULD BE INSPECTED FOR CLOGGING & EXCESSIVE DEBRIS & SEDIMENT ACCUMULATION, AS WELL AS AFTER EVERY STORM GREATER THAN 1 INCH.	FOUR TIMES PER YEAR
NOTE EROSION OF POND BANKS OR BOTTOM.	SEMI-ANNUAL
INSPECT FOR DAMAGE TO THE EMBANKMENT. MONITOR FOR SEDIMENT ACCUMULATION IN THE FACILITY & FOREBAY. EXAMINE TO ENSURE THAT INLET & OUTLET DEVICES ARE FREE OF DEBRIS & OPERATIONAL. INSPECT VEGETATED AREAS FOR EROSION & INVASIVE SPECIES.	ANNUAL
REMOVE SEDIMENT FROM THE FOREBAY (IF APPLICABLE).	5-7 YEAR MAINTENANCE
MONITOR SEDIMENT ACCUMULATIONS, & REMOVE SEDIMENT WHEN THE POND VOLUME HAS BEEN REDUCED BY 25%.	25-50 YEAR MAINTENANCE
GENERAL MAINTENANCE NOTES: 1. SEDIMENT REMOVAL SHOULD BE CONDUCTED WHEN THE BASIN IS COMPLETELY DRY. 2. VEGETATIVE COVER SHOULD BE MAINTAINED AT A MINIMUM OF 95%. 3. IF VEGETATIVE COVER HAS BEEN REDUCED BY 10%, VEGETATION SHOULD BE REESTABLISHED.	

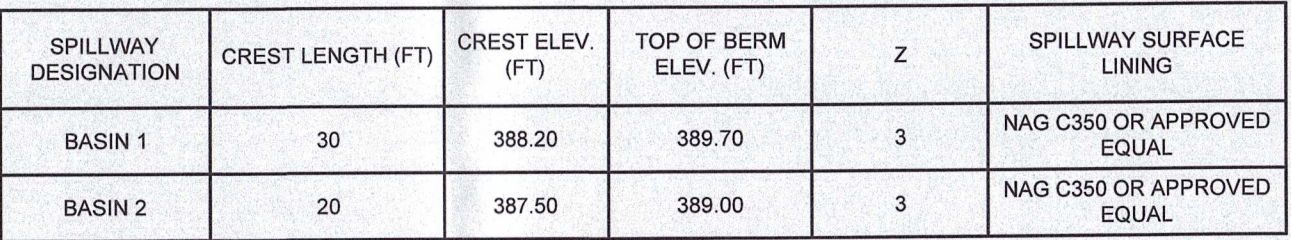
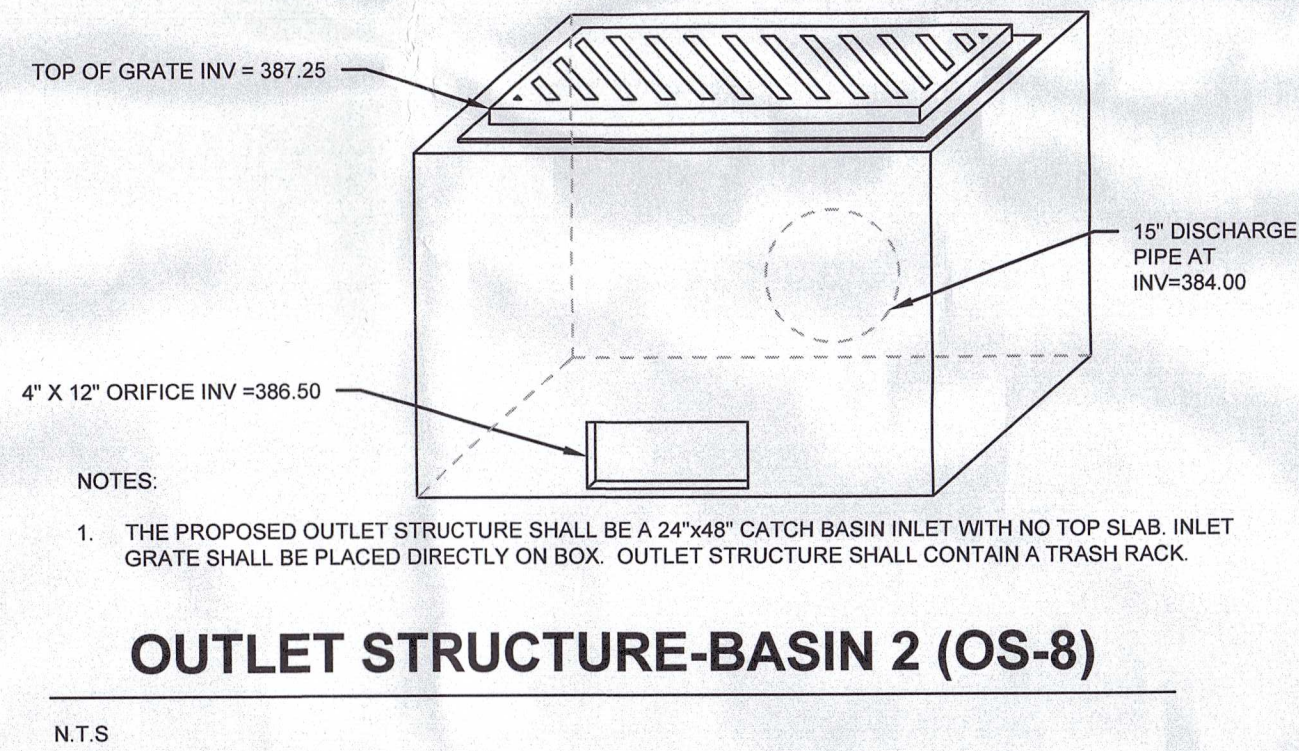

N.T.S



RIPRAP APRON AT PIPE OUTLET WITH FLARED ENWALL

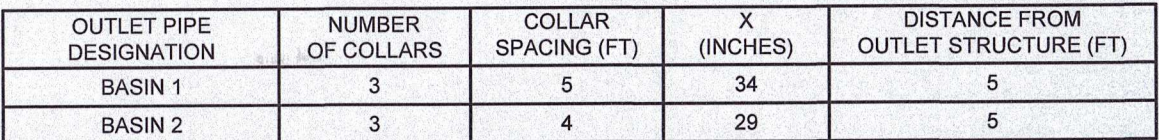

HDPE ANTI-SEEP COLLAR DETAIL



MINOR REVISION TO LAND DEVELOPMENT PLAN
PROPOSED WAREHOUSE AT 2450 GETTYSBURG ROAD
FOR
2500 GETTYSBURG ASSOCIATES, LLC
LOWER ALLEN TOWNSHIP
CUMBERLAND COUNTY

PROFESSIONAL SEAL

DRAWN	AML/MLS
REVIEWED	TLD
SCALE	AS NOTED
DATE	SEPTEMBER 29, 2022
PROJECT NO.	22-0240
CAD FILE:	
09 - DETAILS	

[illegible]

TITLE

DETAILS

SHEET NO.



PROPOSED WAREHOUSE AT 2450 GETTYSBURG ROAD

FOR
2500 GETTYSBURG ASSOCIATES, LLC

LOWER ALLEN TOWNSHIP
CUMBERLAND COUNTY, PENNSYLVANIA

PLAN PREPARERS
INTEGRATED CONSULTING
430 NORTH FRONT STREET
WORMLEYSBURG, PA 17043

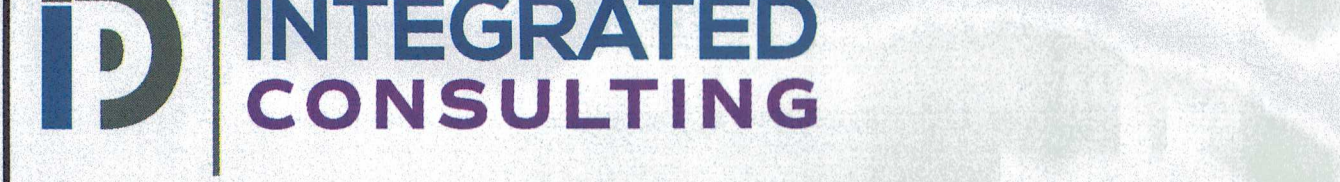

LANDOWNER AND DEVELOPER
2500 GETTYSBURG ASSOCIATES, LLC
1503 LETCHWORTH ROAD
CAMP HILL, PA 17011

CONTACT: BRENT BAUMAN
TELEPHONE: 717-612-1106

RECEIVING STREAMS (WATERSHED):
UNT TO CEDAR RUN CWF, MF

SHEET INDEX

Sheet Number	Sheet Title
01	COVER SHEET
02	EXISTING CONDITIONS PLAN
03	DEMOLITION PLAN
04	POST-CONSTRUCTION STORMWATER MANAGEMENT PLAN
05	PROFILES
06	DETAILS
07	DETAILS

SEED FORMULAS
CONFORMING TO THE PENNSYLVANIA SEED ACT OF 1965 (ACT NO. 187) AND AMENDMENTS, AND REGULATIONS OF THE PENNSYLVANIA DEPARTMENT OF AGRICULTURE, BUREAU OF PLANT INDUSTRY.
HAVE THE PENNSYLVANIA DEPARTMENT OF AGRICULTURE, BUREAU OF PLANT INDUSTRY, CONDUCT PURITY AND GERMINATION ANALYSIS, FOLLOWING THE CURRENT RULES FOR TESTING SEEDS, OF THE ASSOCIATION OF OFFICIAL SEED ANALYSIS.

USE KENTUCKY BLUEGRASS, PERENNIAL RYEGRASS, CREEPING RED FESCUE, CHEWINGS FESCUE, HARD FESCUE, AND BIRDSFOOT TREFOL SEED.
USE SEED, PRETESTED BY THE PENNSYLVANIA DEPARTMENT OF AGRICULTURE, IN 10-POUND (NET) WATERPROOF CONTAINERS, WITH A TAG ATTACHED TO EACH BAG.
USE A PREMIXED SEED WITH AN INSPECTION TAG, STAMPED, DATED, AND SIGNED BY THE DEPARTMENT OF AGRICULTURE INSPECTOR SEWN OR STAPLED TO THE OUTSIDE OF EACH BAG. DO NOT USE SEED FROM CONTAINERS THAT ARE NOT SEALED OR THAT HAVE BEEN STORED WITH HERBICIDES.

DO NOT USE SEED WHICH HAS A TEST DATE OLDER THAN NINE MONTHS.
PERMANENT SEED MIXTURES:

A. LAWN SEEDING MIXTURE:
SPECIES: 15 % PERENNIAL RYEGRASS (BLEND OF 3 IMPROVED HYBRIDS)
25 % FINE LEAF OR CREEPING FESCUE (BLEND OF 3 IMPROVED HYBRIDS)
80 % KENTUCKY BLUEGRASS (BLEND OF 3 IMPROVED HYBRIDS)
SEEDING RATE: 5 LB/1,000 S.F.
SEEDING DATES: AUGUST 15 - OCTOBER 1 AND APRIL 15 - JUNE 15, UNLESS OTHERWISE APPROVED BY OWNER.

MAJOR AMENDMENT POST-CONSTRUCTION STORMWATER MANAGEMENT PLAN

PROPOSED WAREHOUSE AT 2450 GETTYSBURG ROAD

FOR 2500 GETTYSBURG ASSOCIATES, LLC

LOWER ALLEN TOWNSHIP CUMBERLAND COUNTY, PENNSYLVANIA

GENERAL NOTES

PERMIT TERMINATION
UPON PERMANENT STABILIZATION OF THE EARTH DISTURBANCE ACTIVITY UNDER § 102.22(a)(2) (RELATING TO PERMANENT STABILIZATION), AND INSTALLATION OF BMPs IN ACCORDANCE WITH AN APPROVED PLAN PREPARED AND IMPLEMENTED IN ACCORDANCE WITH §§ 102.4 AND 102.8 (RELATING TO EROSION AND SEDIMENT CONTROL REQUIREMENTS; AND PCSM REQUIREMENTS), THE PERMITTEE OR CO-PERMITTEE SHALL SUBMIT A NOTICE OF TERMINATION TO THE DEPARTMENT OR CONSERVATION DISTRICT.

THE NOTICE OF TERMINATION MUST INCLUDE:
(1) THE FACILITY NAME, ADDRESS AND LOCATION.
(2) THE OPERATOR NAME AND ADDRESS.
(3) THE PERMIT NUMBER.
(4) THE REASON FOR PERMIT TERMINATION.
(5) IDENTIFICATION OF THE PERSONS WHO HAVE AGREED TO AND WILL BE RESPONSIBLE FOR LONG-TERM OPERATION AND MAINTENANCE OF THE PCSM BMPs IN ACCORDANCE WITH § 102.8(h)(1) AND PROOF OF COMPLIANCE WITH § 102.8(h)(2).

PCSM REQUIREMENTS
PCSM REPORTING AND RECORD KEEPING: THE PCSM PLAN, INSPECTION REPORTS AND MONITORING RECORDS SHALL BE AVAILABLE FOR REVIEW AND INSPECTION BY THE DEPARTMENT OR THE CONSERVATION DISTRICT.

LICENSED PROFESSIONAL OVERSIGHT OF CRITICAL STAGES: A LICENSED PROFESSIONAL OR A DESIGNER SHALL BE PRESENT ONSITE AND BE RESPONSIBLE DURING CRITICAL STAGES OF IMPLEMENTATION OF THE APPROVED PCSM PLAN. THE CRITICAL STAGES MAY INCLUDE THE INSTALLATION OF UNDERGROUND TREATMENT OR STORAGE BMPs, STRUCTURALLY ENGINEERED BMPs, OR OTHER BMPs AS DEEMED APPROPRIATE BY THE DEPARTMENT OR THE CONSERVATION DISTRICT.

FINAL CERTIFICATION: THE PERMITTEE SHALL INCLUDE WITH THE NOTICE OF TERMINATION "RECORD DRAWINGS" WITH A FINAL CERTIFICATION STATEMENT FROM A LICENSED PROFESSIONAL, WHICH READS AS FOLLOWS:
"I (NAME) DO HEREBY CERTIFY PURSUANT TO THE PENALTIES OF 18 P.A.C.S.A. § 4904 TO THE BEST OF MY KNOWLEDGE, INFORMATION AND BELIEF, THAT THE ACCOMPANYING RECORD DRAWINGS ACCURATELY REFLECT THE AS-BUILT CONDITIONS, ARE TRUE AND CORRECT, AND ARE IN CONFORMANCE WITH CHAPTER 102 OF THE RULES AND REGULATIONS OF THE DEPARTMENT OF ENVIRONMENTAL PROTECTION AND THAT THE PROJECT SITE WAS CONSTRUCTED IN ACCORDANCE WITH THE APPROVED PCSM PLAN, ALL APPROVED PLAN CHANGES AND ACCEPTED CONSTRUCTION PRACTICES."

(1) THE PERMITTEE SHALL RETAIN A COPY OF THE RECORD DRAWINGS AS A PART OF THE APPROVED PCSM PLAN.
(2) THE PERMITTEE SHALL PROVIDE A COPY OF THE RECORD DRAWINGS AS A PART OF THE APPROVED PCSM PLAN TO THE PERSON IDENTIFIED IN THIS SECTION AS BEING RESPONSIBLE FOR THE LONG-TERM OPERATION AND MAINTENANCE OF THE PCSM BMPs.

PCSM LONG TERM OPERATIONS AND MAINTENANCE REQUIREMENTS
UNTIL THE PERMITTEE OR CO-PERMITTEE HAS RECEIVED WRITTEN APPROVAL OF A NOTICE OF TERMINATION, THE PERMITTEE OR CO-PERMITTEE WILL REMAIN RESPONSIBLE FOR COMPLIANCE WITH THE PERMIT TERMS AND CONDITIONS INCLUDING LONG-TERM OPERATION AND MAINTENANCE OF ALL PCSM BMPs ON THE PROJECT SITE AND IS RESPONSIBLE FOR VIOLATIONS OCCURRING ON THE PROJECT SITE. THE DEPARTMENT OR CONSERVATION DISTRICT WILL CONDUCT A FINAL INSPECTION AND APPROVE OR DENY THE NOTICE OF TERMINATION WITHIN 30 DAYS.

THE PERMITTEE OR CO-PERMITTEE SHALL BE RESPONSIBLE FOR LONG-TERM OPERATION AND MAINTENANCE OF PCSM BMPs UNLESS A DIFFERENT PERSON IS IDENTIFIED IN THE NOTICE OF TERMINATION AND HAS AGREED TO LONG-TERM OPERATION AND MAINTENANCE OF PCSM BMPs.

FOR ANY PROPERTY CONTAINING A PCSM BMP, THE PERMITTEE OR CO-PERMITTEE SHALL RECORD AN INSTRUMENT WITH THE RECORDER OF DEEDS WHICH WILL ASSURE DISCLOSURE OF THE PCSM BMP AND THE RELATED OBLIGATIONS IN THE ORDINARY COURSE OF A TITLE SEARCH OF THE SUBJECT PROPERTY. THE RECORDED INSTRUMENT MUST IDENTIFY THE PCSM BMP, PROVIDE FOR NECESSARY ACCESS RELATED TO LONG-TERM OPERATION AND MAINTENANCE FOR PCSM BMPs AND PROVIDE NOTICE THAT THE RESPONSIBILITY FOR LONG-TERM OPERATION AND MAINTENANCE OF THE PCSM BMP IS A COVENANT THAT RUNS WITH THE LAND THAT IS BINDING UPON AND ENFORCEABLE BY SUBSEQUENT GRANTEE, AND PROVIDE PROOF OF FILING WITH THE NOTICE OF TERMINATION UNDER § 102.7(b)(5) (RELATING TO PERMIT TERMINATION).

THE PERSON RESPONSIBLE FOR PERFORMING LONG-TERM OPERATION AND MAINTENANCE MAY ENTER INTO AN AGREEMENT WITH ANOTHER PERSON INCLUDING A CONSERVATION DISTRICT, NONPROFIT ORGANIZATION, MUNICIPALITY, AUTHORITY, PRIVATE CORPORATION OR OTHER PERSON, TO TRANSFER THE RESPONSIBILITY FOR PCSM BMPs OR TO PERFORM LONG-TERM OPERATION AND MAINTENANCE AND PROVIDE NOTICE THEREOF TO THE DEPARTMENT.

A PERMITTEE OR CO-PERMITTEE THAT FAILS TO TRANSFER LONG-TERM OPERATION AND MAINTENANCE OF THE PCSM BMP OR OTHERWISE FAILS TO COMPLY WITH THIS REQUIREMENT SHALL REMAIN JOINTLY AND SEVERALLY RESPONSIBLE WITH THE LANDOWNER FOR LONG-TERM OPERATION AND MAINTENANCE OF THE PCSM BMPs LOCATED ON THE PROPERTY.

CLEAN FILL IS DEFINED AS: UNCONTAMINATED, NON-WATER SOLUBLE, NON-DECOMPOSABLE, INERT, SOLID MATERIAL. THE TERM INCLUDES SOIL, ROCK, STONE, DREDGED MATERIAL, USED ASPHALT, AND BRICK, BLOCK OR CONCRETE FROM CONSTRUCTION AND DEMOLITION ACTIVITIES THAT IS SEPARATE FROM OTHER WASTE AND IS RECOGNIZABLE AS SUCH. THE TERM DOES NOT INCLUDE MATERIALS PLACED IN OR ON THE WATERS OF THE COMMONWEALTH UNLESS OTHERWISE AUTHORIZED. (THE TERM "USED ASPHALT" DOES NOT INCLUDE MILLED ASPHALT OR ASPHALT THAT HAS BEEN PROCESSED FOR RE-USE.)

CLEAN FILL AFFECTED BY A SPILL OR RELEASE OF A REGULATED SUBSTANCE:

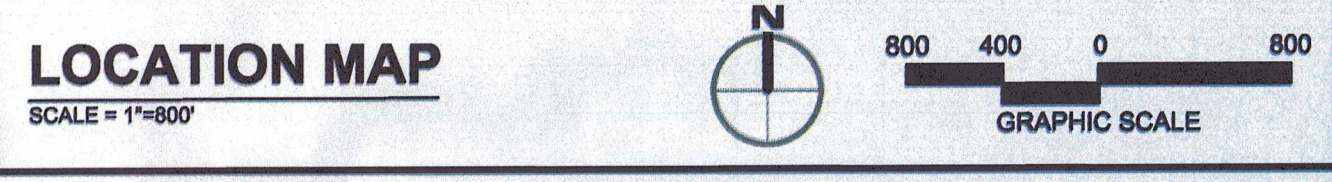
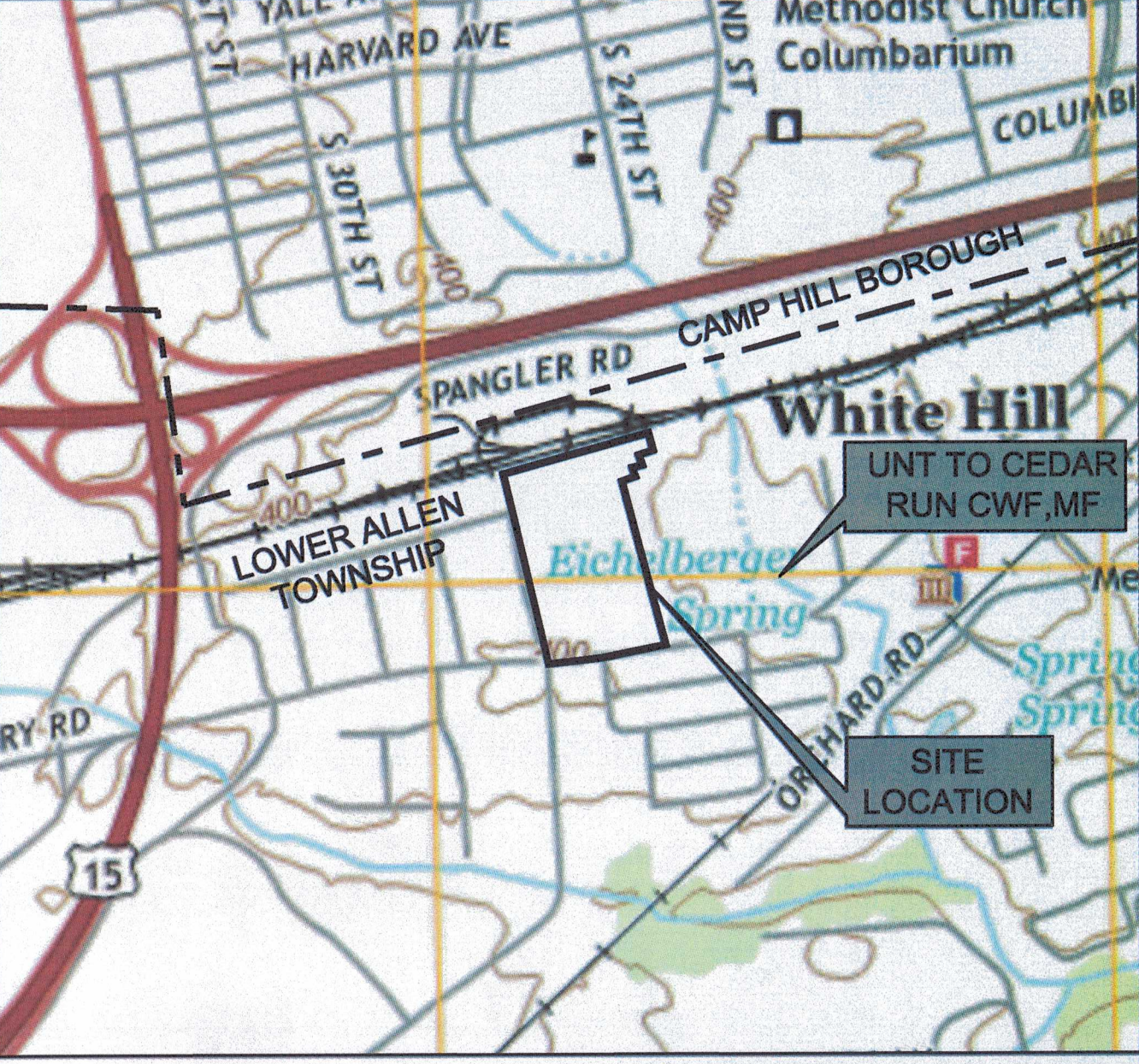

SEQUENCE OF CONSTRUCTION

ALL EARTH DISTURBANCE ACTIVITIES SHALL PROCEED IN ACCORDANCE WITH THE FOLLOWING SEQUENCE. EACH STAGE SHALL BE COMPLETED AND IMMEDIATELY STABILIZED BEFORE ANY FOLLOWING STAGE IS INITIATED. CLEARING, GRUBBING, AND TOPSOIL STRIPPING SHALL BE LIMITED ONLY TO THOSE AREAS DESCRIBED IN EACH STAGE.

IMMEDIATELY UPON DISCOVERING UNFORESEEN CIRCUMSTANCES POSING THE POTENTIAL FOR ACCELERATED EROSION AND/OR SEDIMENT POLLUTION, THE OPERATOR SHALL IMPLEMENT APPROPRIATE BEST MANAGEMENT PRACTICES (BMPs) TO ELIMINATE THE POTENTIAL FOR ACCELERATED EROSION AND/OR SEDIMENT POLLUTION.

AT LEAST 7 DAYS BEFORE STARTING ANY EARTH DISTURBANCE ACTIVITIES, THE OWNER AND/OR OPERATOR SHALL INVITE ALL CONTRACTORS INVOLVED IN THOSE ACTIVITIES, THE LANDOWNER, ALL APPROPRIATE MUNICIPAL OFFICIALS, THE PCSM & EROSION AND SEDIMENT CONTROL PLAN PREPARER, AND A REPRESENTATIVE OF THE CUMBERLAND COUNTY CONSERVATION DISTRICT (CCCD) TO AN ON-SITE PRE-CONSTRUCTION MEETING.

CONTACT THE CCCD A MINIMUM OF THREE (3) DAYS PRIOR TO EARTH MOVING ACTIVITIES.

AT LEAST 3 DAYS BEFORE STARTING ANY EARTH DISTURBANCE ACTIVITIES, ALL CONTRACTORS INVOLVED IN THOSE ACTIVITIES SHALL NOTIFY THE PENNSYLVANIA ONE CALL SYSTEM AT 1-800-242-1776 FOR THE LOCATION OF EXISTING UNDERGROUND UTILITIES.

ALL PUMPING OF SEDIMENT LADEN WATER SHALL BE THROUGH A SEDIMENT CONTROL BMP, SUCH AS A PUMPED WATER FILTER BAG OR EQUIVALENT FACILITY, OVER UNDISTURBED VEGETATED AREAS.

CONTRACTOR SHALL FIELD MARK ALL WATER OF THE COMMONWEALTH, INCLUDING STREAM BUFFERS, WETLAND BOUNDARIES, SPRING SEEDS, AND FLOODWAYS WITHIN THE LIMIT OF DISTURBANCE PRIOR TO EARTH DISTURBANCE.

CONTRACTOR SHALL FIELD MARK THE LIMIT OF DISTURBANCE WITH ORANGE CONSTRUCTION FENCE OR OTHER MEASURES APPROVED BY CCCD AND THE ENGINEER PRIOR TO EARTH DISTURBANCE.

ALL BUILDING MATERIALS AND WASTES MUST BE REMOVED FROM THE SITE AND RECYCLED OR DISPOSED OF IN ACCORDANCE WITH THE DEPARTMENTS SOLID WASTE MANAGEMENT REGULATIONS AT 26 PA. CODE CHAPTER 260.1 ET SEQ., 271.1, AND 287.1 ET. SEQ. NO BUILDING MATERIALS OR WASTES OR UNUSED BUILDING MATERIALS SHALL BE BURNED, BURIED, DUMPED, OR DISCHARGED AT THE SITE.

UNDERLINED ITEMS INDICATE A CRITICAL STAGE OF PCSM CONSTRUCTION THAT REQUIRES PROFESSIONAL OVERSIGHT. THE PA LICENSED PROFESSIONAL RESPONSIBLE FOR PREPARATION OF THE PCSM PLAN, OR THEIR DESIGNEE, SHALL BE CONTACTED A MINIMUM OF 48 HOURS IN ADVANCE OF ALL CRITICAL STAGES OF CONSTRUCTION TO PROVIDE OVERSIGHT.

1. THE LIMIT OF DISTURBANCE AND CLEARING LIMITS SHALL BE PHYSICALLY MARKED IN THE FIELD PRIOR TO THE START OF WORK ON THE SITE.

2. CONSTRUCT THE TEMPORARY ROCK CONSTRUCTION ENTRANCE WITH WASH RACK AND CONCRETE WASHOUT AREA AS SHOWN ON THE PLANS. ALL VEHICLES ENTERING THE SITE SHALL DO SO VIA THE ROCK CONSTRUCTION ENTRANCE(S). ANY MUD OR SEDIMENT TRACKED ONTO MACADAM ROADWAYS SHALL BE REMOVED BY THE CONTRACTOR AT THE END OF EACH WORKING DAY. WASHING OF THE ROADWAY IS NOT PERMITTED. THE CONTRACTOR IS ALSO RESPONSIBLE FOR ALL TRAFFIC CONTROL DEVICES ASSOCIATED WITH THE ACCESS DRIVE THROUGHOUT THE TERM OF CONSTRUCTION ACTIVITIES.

3. INSTALL ALL SEGMENTS OF SILT SOCK AS SHOWN ON THE PLANS. INSTALL INLET PROTECTION IN EXISTING INLETS AS SHOWN ON THE PLANS.

4. CLEAR, GRUB, AND STRIP TOPSOIL WITHIN THE AREA OF THE PROPOSED SEDIMENT TRAPS AND STOCKPILE AT THE TEMPORARY AREAS PROVIDED. STOCKPILE HEIGHTS MUST NOT EXCEED 36 FEET, AND SIDE SLOPES MUST ALSO BE 2:1 OR FLATTER. SURROUND WITH SILT SOCK AND SEED PER TEMPORARY SEEDING SPECIFICATIONS, FERTILIZE, AND MULCH.

5. BEGIN CONSTRUCTION/EXCAVATION OF THE TEMPORARY SEDIMENT TRAPS AS SHOWN ON THE PLANS INCLUDING THE FOLLOWING:
a. TEMPORARY SKIMMER AND STONE LANDING BERM.
b. CLEANOUT STAKES AND APPROPRIATELY MARK THE SEDIMENT CLEANOUT VOLUME ELEVATION
c. PERMANENT PIPE AND OUTLET STRUCTURE INCLUDING STAINLESS STEEL PLATE
d. CLAY CORE AND KEY TRENCH
e. ANTI-SEEP COLLARS
f. EMERGENCY SPILLWAY

6. INSTALL SWALE #1 AND STORMWATER CONVEYANCE PIPES FROM ENDWALLS TO UPSTREAM INLETS. INSTALLATION SHALL BE FROM DOWNSTREAM TO UPSTREAM. IMMEDIATELY INSTALL FABRIC LINING TO SWALE #1 AND SEED/MULCH REMAINING AREAS OF THE SWALE.

7. WHEN THE TRAPS ARE COMPLETED TO THE GRADES SHOWN ON THE GRADING PLAN, SEED THE ENTIRE TRAP SURFACES WITH PERMANENT GRASS SEED MIXTURE. MAINTAIN THE TRAPS THROUGHOUT CONSTRUCTION OF THE SITE UNTIL ALL EARTHWORK IS FINISHED AND STABILIZED.

8. CLEAR, GRUB, AND STRIP TOPSOIL WITHIN THE AREA OF REMAINING PROPOSED IMPROVEMENTS AND STOCKPILE AT THE TEMPORARY AREAS PROVIDED. DEMOLISH ITEMS AS SHOWN ON THE PLANS. STOCKPILE HEIGHTS MUST NOT EXCEED 36 FEET, AND SIDE SLOPES MUST ALSO BE 2:1 OR FLATTER. SURROUND WITH SILT SOCK AND SEED PER TEMPORARY SEEDING SPECIFICATIONS, FERTILIZE, AND MULCH. BEGIN CUTTING AND FILLING AREAS AS NEEDED TO ACHIEVE GRADES AS SHOWN ON THE PLAN. ENSURE THAT ALL RUN-OFF IS DIRECTED TO THE SEDIMENT TRAPS AND/OR E&S CONTROLS AS SHOWN ON THE PLANS. INSTALL EROSION CONTROL MATTING AS SHOWN ON THE PLANS.

9. UPON ACHIEVING FINAL ELEVATION IN THE PROPOSED BUILDING PAD AREA, EXCAVATE THE BUILDING FOOTERS. POUR CONCRETE FOR FOOTERS. AND CONSTRUCT FOUNDATION WALL. WHEN CONDITIONS WARRANT, THE FOOTERS AND FOUNDATION WALLS MAY BE BACKFILLED. FILL MATERIAL SHALL BE FREE OF ROOTS, SOD, AND OTHER ORGANIC MATERIAL, FROZEN SOIL, STONES, AND DISCARDED CONSTRUCTION MATERIAL. THE FILL SHALL BE PLACED IN 8" LAYERS, WITH EACH LAYER BEING ROLLED AND COMPACTED PRIOR TO THE NEXT LAYER BEING PLACED. WHEN THE AREA REACHES THE PREScribed ELEVATION, THE SUBBASE SHOULD BE THOROUGHLY ROLLED AND COMPACTED TO ELIMINATE ANY SOFT OR UNSETTLED AREAS.

10. INSTALL ALL CURBING, STORMWATER COLLECTION AND CONVEYANCE FACILITIES, SIDEWALKS, WATER SERVICE PIPING, SANITARY SEWER PIPING, AND OTHER SITE UTILITIES. STORMWATER CONVEYANCE PIPING SHALL BE INSTALLED STARTING DOWNSTREAM AND WORKING UPSTREAM. UPON CONCRETE FINISHING, BACKFILL THE CURBING, SEED, FERTILIZE, AND MULCH THE AREA TO ESTABLISH GRASS COVER. INSTALL STONE SUB-BASE OVER ALL AREAS TO RECEIVE PAVING. INSTALL ALL TREES, SHRUBS, PLANTINGS, GROUND COVER, MULCH, AND DECORATIVE STONE. INSTALL RAIN GARDEN AS SHOWN ON THE PLANS.

11. REPLACE TOPSOIL AND STABILIZE ALL EXPOSED OR DISTURBED AREAS BY PERFORMING FINAL GRADING OPERATIONS AT THE SOIL MATERIAL STOCKPILE AREAS. SEED, FERTILIZE, AND MULCH EXPOSED OR DISTURBED AREAS.

12. APPLY PAVEMENT TO ALL AREAS INDICATED ON THE PLANS.

13. THE CONTRACTOR SHALL FLUSH ALL STORM SEWER PIPES AFTER THE SITE IS COMPLETELY STABILIZED.

14. UPON COMPLETION OF ALL EARTH DISTURBANCE ACTIVITIES AND PERMANENT STABILIZATION OF ALL DISTURBED AREAS, THE OWNER AND/OR OPERATORS SHALL CONTACT THE CUMBERLAND COUNTY CONSERVATION DISTRICT FOR AN INSPECTION PRIOR TO THE REMOVAL OF E&S BMPs.

15. WHEN ALL TRIBUTARY AREAS TO THE SEDIMENT TRAPS ARE COMPLETELY STABILIZED, AND APPROVAL HAS BEEN GRANTED BY THE CONSERVATION DISTRICT, CONVERT THE TRAPS INTO A PERMANENT SWM INFILTRATION BASIN BY DEWATERING AND REMOVING THE TEMPORARY SKIMMERS WITH LANDING BERMS AND CLEANOUT STAKES.

16. PER THE GEOTECHNICAL ENGINEERING REPORT, OVER-EXCAVATE THE BASIN BOTTOM ELEVATION BY 24" TO PROVIDE THE REQUIRED PLANTING SOIL MIX. IF EXCAVATION INTO BEDROCK IS REQUIRED TO ACHIEVE DESIRED ELEVATIONS, PROVIDE ASHTO NO. 57 BED, AS REQUIRED, PER THE GEOTECHNICAL ENGINEERING REPORT. ROCK TO THE PLANTING SOIL MIX ARE PRESENT IN THE BASIN SUBGRADE. FILTER FABRIC AND GEOTEXTILE SHOULD BE PLACED ON THE EXCAVATED SURFACE PRIOR TO PLACEMENT OF THE PLANTING SOIL MIX. IF THE SUBGRADE CONSISTS OF ALL ROCK, FILTER FABRIC ALONE CAN BE USED. REFER TO THE BASIN CROSS-SECTION PROFILES ON SHEET 5 OF 7 AND THE GEOTECHNICAL ENGINEERING REPORT.

17. INSTALL THE FOLLOWING:
a. REMOVE STAINLESS STEEL ORIFICE PLATE
b. INSTALL ORIFICE TRASH RACK
c. INSTALL 6" DEWATERING ORIFICE AND VALVE
d. PERFORM ALL EXCAVATION ACTIVITIES REQUIRED TO BRING THE BASIN AND ITS VICINITY TO THE FINISHED GRADE OF THE PERMANENT SWM BASIN.
e. INSTALL SAND/SOIL MIX AND ASHTO NO. 57 BED, AS REQUIRED, PER THE GEOTECHNICAL ENGINEERING REPORT
f. BASIN SEEDING AS SHOWN ON THE PLANS
g. VERIFICATION TESTING OF THE FULLY CONSTRUCTED BASINS WILL BE PERFORMED BY A GEOTECHNICAL ENGINEER TO ENSURE PROPER PERFORMANCE OF THE FINAL CONDITIONS, INCLUDING INFILTRATION RATES.
g.a. IF VERIFIED INFILTRATION RATES EXCEED 6"/HR. UNDER THE DIRECTION OF THE GEOTECHNICAL ENGINEER THE PLANTING SOIL MIX SHOULD BE REMOVED BY A MORE-FINE GRAINED SOIL AND/OR COMPACTED WHEN REPLACED TO REDUCE THE INFILTRATION RATE.
IMMEDIATELY STABILIZE AND SEED ALL DISTURBED AREAS IN THE VICINITY OF THE BASIN. THE BASIN SHOULD NOT BE CONVERTED DURING NON-GERMINATING PERIODS. CONTRACTOR SHALL REPAIR AND PERMANENTLY STABILIZE THE AREAS DISTURBED DURING REMOVAL OF THE TEMPORARY BMPs.



430 NORTH FRONT STREET
WORMLEYSBURG, PA 17043
717.775.6004
www.integratedconsultingllc.com

MAJOR AMENDMENT TO
POST-CONSTRUCTION STORMWATER MANAGEMENT PLAN

PROPOSED WAREHOUSE AT 2450 GETTYSBURG ROAD

FOR
2500 GETTYSBURG ASSOCIATES, LLC

LOWER ALLEN TOWNSHIP
CUMBERLAND COUNTY

PROFESSIONAL SEAL

DRAWN TLD
REVIEWED JLK
SCALE AS NOTED
DATE 10/11/2022
PROJECT NO. 22-0240
CAD FILE:
01 - PCSM COVERSHEET

REVISIONS

NO.	DATE	DESCRIPTION
1	11/09/2022	REVISED PER CCCD REVIEW COMMENTS
2	12/07/2022	REVISED PER CCCD TECHNICAL REVIEW COMMENTS

TITLE
COVER SHEET

SHEET NO.
01 of 07

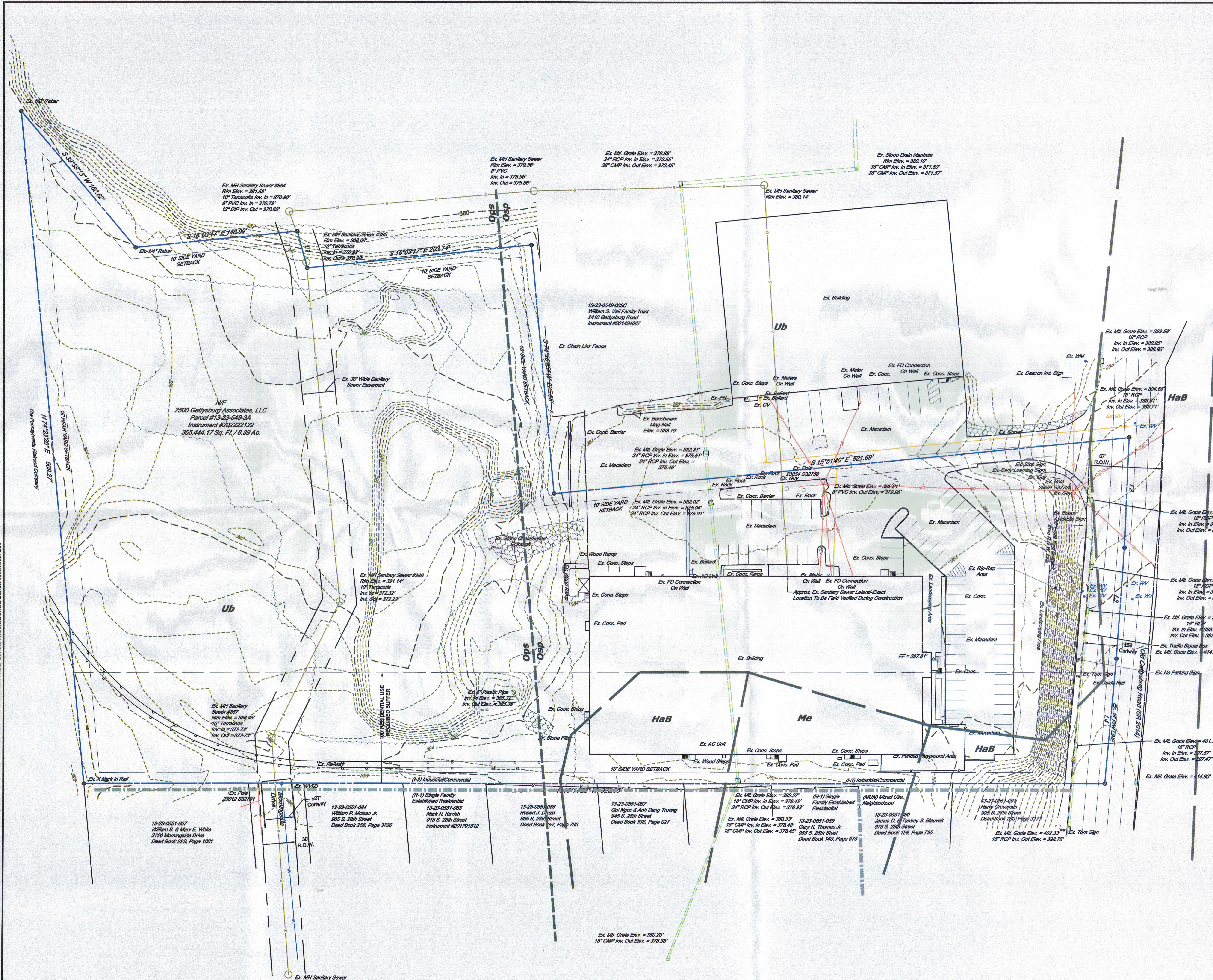

LEGEND

EXISTING CONDITIONS PLAN

- EXISTING MAJOR CONTOUR
- EXISTING MINOR CONTOUR
- EXISTING OVERHEAD ELECTRIC
- EXISTING UTILITY POLE
- EXISTING GAS VALVE
- EXISTING GAS LINE
- EXISTING WATER HYDRANT
- EXISTING WATER VALVE
- EXISTING WATERLINE
- EXISTING SANITARY SEWER LINE
- EXISTING SANITARY MANHOLE
- EXISTING EASEMENT
- EXISTING SETBACK
- EXISTING PROPERTY LINE
- EXISTING PROPERTY CORNER
- EXISTING INLET STRUCTURE
- EXISTING STORM MANHOLE
- EXISTING SIGN
- EXISTING EDGE OF MACADAM
- EXISTING EDGE OF CONCRETE
- EXISTING LIGHT STANDARD
- EXISTING BOLLARD
- EXISTING TREE
- EXISTING STORM PIPE
- EXISTING TREELINE
- EXISTING CURB
- SOIL TYPE BOUNDARY LINE
- CoB2 SOIL TYPE
- EXISTING RIP RAP
- EXISTING BENCH MARK
- GEOLGY BOUNDARY LINE
- ZONING BOUNDARY

SURVEY NOTES

- TO THE BEST OF MY PROFESSIONAL KNOWLEDGE THERE ARE NO ENVIRONMENTALLY SENSITIVE AREAS PRESENT.
- PROPOSED USE OF THIS PLAN IS TO SHOW EXISTING FEATURES AND BOUNDARY LINES.
- BOUNDARY AND TOPOGRAPHIC SURVEY PERFORMED BY A TO Z LAND CONSULTING SERVICES LLC, FEBRUARY 2020. HORIZONTAL DATUM NAD 83 AND PA SOUTH ZONE.
- VERTICAL DATUM NAVD83.
- PA ONE CALL #2022282093.

LINE TABLE

LINE	BEARING	DISTANCE
L1	S 84°39'40" W	34.45'
L2	S 82°24'20" W	100.12'
L3	S 83°50'20" W	100.12'
L4	S 84°27'54" W	113.05'

SOILS INFORMATION

HaB Hagerstown Silty Loam
3 TO 8 PERCENT SLOPES
(Non-Hydrated)
Hsa

Me Melvin Silty Loam
0 TO 2 PERCENT
HSG B/D (Hydro)
0-12" to Seasonal High Water Table

Ud Urban land and Uplands
0 TO 8 PERCENT SLOPES
(Non-Hydrated)
HSG D

Geologic Information

Osp St. Paul Group

Ops Pineburg Station Formation

PROFESSIONAL SEAL

DRAWN: AML/MLS
REVIEWED: TLD
SCALE: AS NOTED
DATE: 10/11/2022
PROJECT NO.: 22-0240
CAD FILE: 02 - EXISTING CONDITIONS

REVISIONS

NO.	DATE	DESCRIPTION
1	11/29/2022	REVISED PER COCD REVIEW COMMENTS
2	12/27/2022	REVISED PER COCD TECHNICAL REVIEW COMMENTS

TITLE

EXISTING CONDITIONS PLAN

SHEET NO.

02 of 07

INTEGRATED CONSULTING

430 NORTH FRONT STREET
WORMLEYSBURG, PA 17043
717.773.6084
www.integratedconsultingllc.com

MAJOR AMENDMENT TO EROSION & SEDIMENTATION CONTROL PLAN

PROPOSED WAREHOUSE AT 2450 GETTYSBURG ROAD

FOR 2500 GETTYSBURG ASSOCIATES, LLC

LOWER ALLEN TOWNSHIP

CUMBERLAND COUNTY

10/10/2022 2:56:38 PM, DEFAULT, CUMBERLAND COUNTY, LOWER ALLEN TOWNSHIP, 2500 GETTYSBURG ROAD, PROPOSED WAREHOUSE AT 2450 GETTYSBURG ROAD, POST-CONSTRUCTION STORMWATER MANAGEMENT PLAN, DEMOLITION PLAN, LOWER ALLEN TOWNSHIP, CUMBERLAND COUNTY

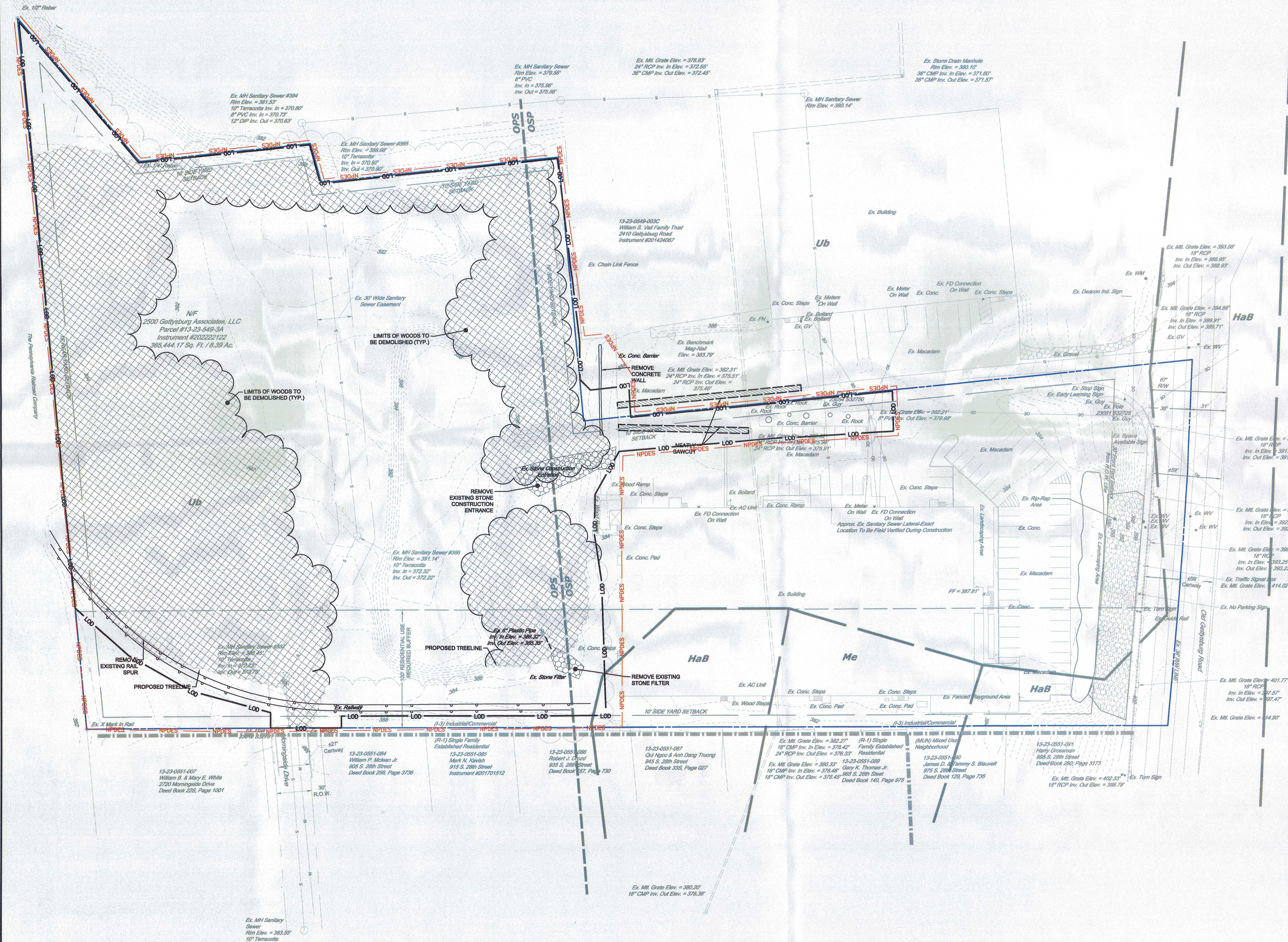

- LEGEND**
- DEMOLITION PLAN
- DEMOLISH MACADAM
 - PROPOSED SAW CUT LINE
 - EXISTING PROPERTY LINE
 - LOD
 - LIMIT OF DISTURBANCE
 - NPDES
 - NPDES BOUNDARY

DEMOLITION PLAN NOTES

1. SEDIMENT AND EROSION CONTROLS AS SHOWN ON THE SEDIMENT AND EROSION CONTROL PLAN AND/OR DEMOLITION PLAN SHALL BE INSTALLED BY THE DEMOLITION CONTRACTOR PRIOR TO START OF DEMOLITION AND CLEARING AND GRUBBING OPERATIONS.
2. REMOVE AND DISPOSE OF ANY DEBRIS AND RUBBISH REQUIRING REMOVAL FROM THE WORK AREA IN AN APPROVED OFF SITE LANDFILL, BY AN APPROVED HAULER. HAULER SHALL COMPLY WITH ALL REGULATORY REQUIREMENTS.
3. THE CONTRACTOR SHALL SECURE ALL PERMITS FOR HIS DEMOLITION AND DISPOSAL OF HIS DEMOLITION MATERIAL TO BE REMOVED FROM THE SITE. THE CONTRACTOR SHALL POST BONDS AND PAY PERMIT FEES AS REQUIRED. BUILDING DEMOLITION CONTRACTOR SHALL BE RESPONSIBLE FOR PERMITS AND DISPOSAL OF ALL BUILDING DEMOLITION DEBRIS IN AN APPROVED OFF-SITE LANDFILL.
4. THE CONTRACTOR SHALL CUT AND PLUG, OR ARRANGE FOR THE APPROPRIATE UTILITY PROVIDER TO CUT AND PLUG ALL SERVICE PIPING AT THE STREET LINE OR AT THE MAIN, AS REQUIRED BY THE UTILITY PROVIDER, OR AS OTHERWISE NOTED OR SHOWN ON THE CONTRACT DRAWINGS. ALL SERVICES MAY NOT BE SHOWN ON THIS PLAN. THE CONTRACTOR SHALL INVESTIGATE THE SITE PRIOR TO BIDDING TO DETERMINE THE EXTENT OF SERVICE PIPING TO BE REMOVED, CUT OR PLUGGED. THE CONTRACTOR SHALL PAY ALL UTILITY PROVIDER FEES FOR ABANDONMENTS AND REMOVALS.
5. THE CONTRACTOR SHALL PROTECT ALL IRON PINS, MONUMENTS AND PROPERTY CORNERS DURING DEMOLITION AND CONSTRUCTION ACTIVITIES. ANY CONTRACTOR DISTURBED PINS, MONUMENTS, AND OR PROPERTY CORNERS, ETC. SHALL BE RESET BY A LICENSED LAND SURVEYOR AT THE EXPENSE OF THE CONTRACTOR.
6. THE DEMOLITION CONTRACTOR SHALL STABILIZE THE SITE AND KEEP EROSION CONTROL MEASURES IN PLACE UNTIL THE COMPLETION OF HIS WORK OR UNTIL THE COMMENCEMENT OF WORK BY THE SITE CONTRACTOR, WHICHEVER OCCURS FIRST, AS REQUIRED OR DEEMED NECESSARY BY THE ENGINEER OR OWNER'S REPRESENTATIVE. THE SITE CONTRACTOR SHALL ASSUME RESPONSIBILITY FOR THE MAINTENANCE OF EXISTING EROSION AND SEDIMENTATION CONTROLS AND FOR INSTALLATION OF ANY NEW SEDIMENT AND EROSION CONTROLS AS PER THE SEDIMENT AND EROSION CONTROL PLAN, AT THAT TIME.
7. THE CONTRACTOR SHALL ARRANGE FOR AND INSTALL TEMPORARY OR PERMANENT UTILITY CONNECTIONS WHERE INDICATED ON PLAN OR AS REQUIRED. MAINTAIN UTILITY SERVICES TO BUILDINGS OR TO SERVICES TO REMAIN. CONTRACTOR TO COORDINATE WITH UTILITY PROVIDERS FOR INSTALLATION AND PAY UTILITY PROVIDER FEES.

MAJOR AMENDMENT TO
POST-CONSTRUCTION STORMWATER MANAGEMENT PLAN
PROPOSED WAREHOUSE AT 2450 GETTYSBURG ROAD
FOR
2500 GETTYSBURG ASSOCIATES, LLC
LOWER ALLEN TOWNSHIP
CUMBERLAND COUNTY

PROFESSIONAL SEAL

DRAWN	TLD
REVIEWED	JLK
SCALE	AS NOTED
DATE	10/11/2022
PROJECT NO.	22-0240
CAD FILE:	03 - DEMOLITION PLAN

REVISIONS	NO.	DATE	DESCRIPTION
	1	11/29/2022	REVISED PER CDD REVIEW COMMENTS
	2	12/27/2022	REVISED PER CDD TECHNICAL REVIEW COMMENTS

TITLE
DEMOLITION
PLAN

SHEET NO.
03 of 07

12/22/2022 3:57:57 PM, DEFAULT, CUMBERBURG FAULT, DEBATOR-CICAWATER INTEGRATED DEVELOPMENT PARTNERS, LLC - DATA PROJECT 320205-008, JN - LOWER ALLEN TOWNSHIP POST-CONSTRUCTION STORMWATER MANAGEMENT PLAN.

© 2022 INTEGRATED CONSULTING. THESE DRAWINGS SHALL NOT BE UTILIZED BY ANY PERSON, FIRM OR CORPORATION WITHOUT THE SPECIFIC WRITTEN PERMISSION OF INTEGRATED CONSULTING.

SOILS INFORMATION

HaB Hagerstown Silty Loam
5 TO 8 PERCENT SLOPES
(Non-Hydric)
Hsa

Me Melvin Silty Loam
0 TO 2 PERCENT
HSG B2D (Hydric)
0-12" to Seasonal High Water Table

Ud Urban land and Upland
0 TO 8 PERCENT SLOPES
(Non-Hydric)
HSG D

GEOLOGIC INFORMATION

Osp St. Paul Group
Ops Pinesburg Station Formation

LEGEND

GRADING & DRAINAGE PLAN

310
308

307.88
TC 310.17
BC 308.50

310.20
H.P.

1.00%

PROPOSED MAJOR CONTOUR
PROPOSED MINOR CONTOUR
PROPOSED SPOT ELEVATION
PROPOSED SPOT ELEVATION:
TOP OF CURB
BOTTOM OF CURB
PROPOSED SPOT ELEVATION:
HIGH POINT

PROPOSED SLOPE ARROW

PROPOSED STORM LINE
PROPOSED STORM MANHOLE
PROPOSED STORM INLET
PROPOSED ROOF DRAIN
PROPOSED CLEANOUT
CLAY CORE
PROPOSED WATER LINE
PROPOSED WATER VALVE
PROPOSED FIRE HYDRANT
PROPOSED SANITARY LINE
PROPOSED GAS LINE
PROPOSED UNDERGROUND
ELECTRIC
PROPOSED OVERHEAD
ELECTRIC
UTILITY POLE

NPDES
LOD

PCSM BMP
DISCHARGE POINT
PCSM BMP DRAINAGE AREA
TP-5
INFILTRATION TEST PIT LOCATION
CLAY CORE
BASIN SEED MIX

PCSM NOTES

- THE CONTRACTOR SHALL PRESERVE EXISTING VEGETATION WHERE POSSIBLE AND/OR AS NOTED ON DRAWINGS. REFER TO SEDIMENT AND EROSION CONTROL PLAN FOR LIMIT OF DISTURBANCE AND EROSION CONTROL NOTES (UNDER SEPARATE COVER).
- TOPSOIL SHALL BE STRIPPED AND STOCKPILED ON SITE FOR USE IN FINAL LANDSCAPING.
- THE CONTRACTOR SHALL COMPACT FILL IN LIFT THICKNESS PER THE GEOTECHNICAL REPORT UNDER ALL PARKING, BUILDING, DRIVE, AND STRUCTURE AREAS TO 98% OF THE MAXIMUM DRY DENSITY AS DETERMINED BY ASTM D1557 (MODIFIED PROCTOR TEST), OR AS REQUIRED BY THE GEOTECHNICAL ENGINEER.
- CONSTRUCTION IS EXPECTED TO BEGIN IN SPRING 2020 & CONTINUE THROUGH SUMMER OF 2021.
- THE LIMIT OF DISTURBANCE (LOD) IS 5.1 ACRES AND THE NPDES PERMIT BOUNDARY IS 5.5 ACRES. WHERE BOTH THE NPDES PERMIT BOUNDARY AND LOD FOLLOW THE PROPERTY LINE, THE NPDES PERMIT BOUNDARY IS SHOWN AS AN OFFSET OF THE LOD FOR GRAPHICAL REPRESENTATION ONLY.
- ACCORDING TO 6MAP, THE RECEIVING WATER IS AN UNNAMED TRIBUTARY TO CEDAR RUN, A CHAPTER 93 DESIGNATED CWF, MF.
- THE PROPOSED RAIN GARDEN IS INTENDED TO SERVE AS A LANDSCAPE FEATURE AND IS NOT PROPOSED A POST CONSTRUCTION BEST MANAGEMENT PRACTICE (BMP) FOR WATER QUALITY OR VOLUME CREDITS.

SOIL LIMITATIONS AND RESOLUTIONS

LIMITATIONS:

- CUTBANKS CAVE
- CORROSION OF UNCOATED STEEL & CONCRETE
- HYDRIC / HYDRIC INCLUSIONS
- LOW STRENGTH, LANDSLIDE PRONE
- SLOW PERCOLATION
- PIPING
- POOR SOURCE OF TOPSOIL
- Moderate potential for frost action
- LOW SHRINK/SWELL
- WETNESS

RESOLUTION:

- EXCAVATIONS WILL BE PROPERLY SUPPORTED BY SHEETING AND SHORING TO PREVENT CAVES.
- NO STEEL IS EXPECTED TO BE IN DIRECT CONTACT WITH SOILS.
- NO WETLANDS ARE PRESENT IN THE DEVELOPMENT AREA.
- A MAXIMUM OF 3:1 SLOPES ARE PROPOSED.
- A FIELD INVESTIGATION OF PERCOLATION RATES AT THE INFILTRATION AREAS WAS PERFORMED TO VERIFY THE SOILS PERCOLATION CAPACITY.
- WATERTIGHT PIPE, ANTI-SEEP COLLARS, CLAY CORES THROUGH BASIN BERMS, AND CONCRETE ENDWALLS WILL BE USED TO MINIMIZE THE DANGER OF PIPING.
- EXISTING TOPSOIL, WHICH HAS PROVEN TO BE SUITABLE WILL BE REUSED ON THE SITE.
- PAVEMENT SUB-BASE WILL BE PROVIDED TO MINIMIZE FROST AFFECTS.
- STONE BASE WILL BE PROVIDED TO PREVENT SHRINK-SWELL FROM EFFECTING PAVEMENT.
- PROVIDE POSITIVE DRAINAGE ACROSS THE SITE.

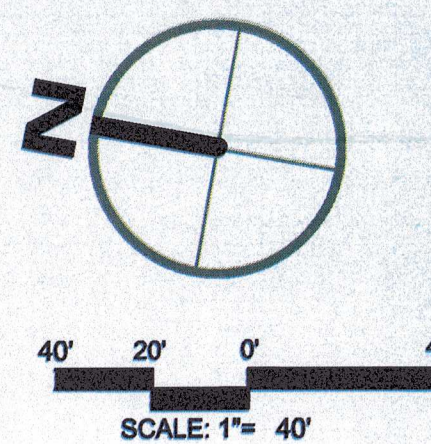

PROFESSIONAL SEAL

DRAWN	TLD
REVIEWED	JLK
SCALE	AS NOTED
DATE	10/11/2022
PROJECT NO.	22-0240
CAD FILE:	04 - PCSM PLAN

NO.	DATE	DESCRIPTION
1	11/09/2022	REVISION PER CDD REVIEW COMMENTS
2	12/27/2022	REVISION PER CDD TECHNICAL REVIEW COMMENTS

TITLE POST-CONSTRUCTION STORMWATER MANAGEMENT PLAN

SHEET NO.

04 of 07

Native Detention Area Mix (ERN/IMX-183)		
Seeding Rate	20 lb per acre, or 1/2 lb per 1,000 sq ft	
Mix Type	Storm Water Management Facility Sites	
Species List	25%	Deertongue, 'Tioga' (<i>Panicum clandestinum</i> (<i>Dichanthelium</i> c.), 'Tioga')
	25%	Sod Sedge, PA Ecotype (<i>Carex vulpinoidea</i> , PA Ecotype)
	20%	Virginia Wildrye, PA Ecotype (<i>Elymus virginicus</i> , PA Ecotype)
	20%	Switchgrass, 'Shawnee' (<i>Panicum virgatum</i> , 'Shawnee')
	5%	Autumn Bentgrass, PA Ecotype (<i>Agrostis perennans</i> , PA Ecotype)
	2%	Ticklegrass (Rough Bentgrass), PA Ecotype (<i>Agrostis scabra</i> , PA Ecotype)
	1%	Soft Rush (<i>Juncus effusus</i>)
	1%	Path Rush, PA Ecotype (<i>Juncus tenuis</i> , PA Ecotype)
1%	Green Bulrush, PA Ecotype (<i>Scirpus atrovirens</i> , PA Ecotype)	



DRAWN	TLD
REVIEWED	JLK
SCALE	AS NOTED
DATE	10/11/2022
PROJECT NO.	22-0240
CAD FILE:	
05 - PROFILES	

[illegible]

SHEET NO.

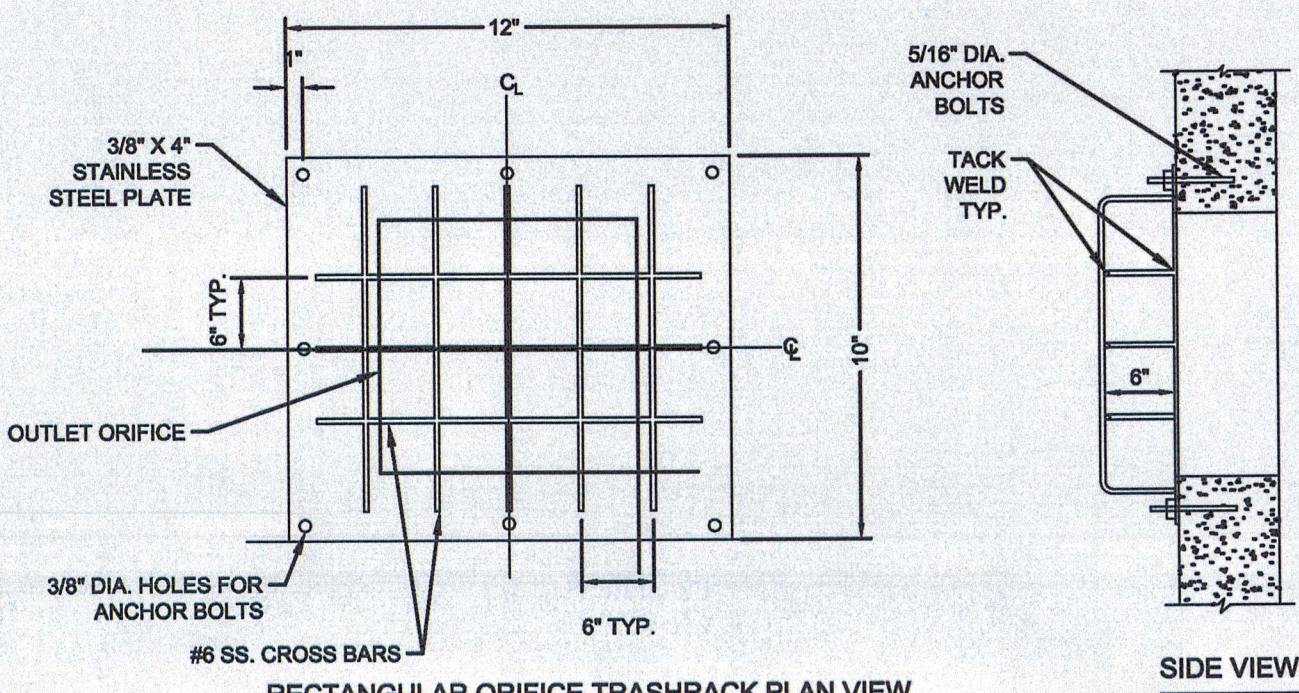

- NOTES:
1. TRASH RACK MATERIAL TO BE STAINLESS STEEL.
 2. SECURE THE TRASHRACK PLATE TO THE SIDE OF THE INLET BOX USING 5/16\"/>

BASIN #1 TRASH RACK FOR RECTANGULAR OUTLET STRUCTURE OS-7

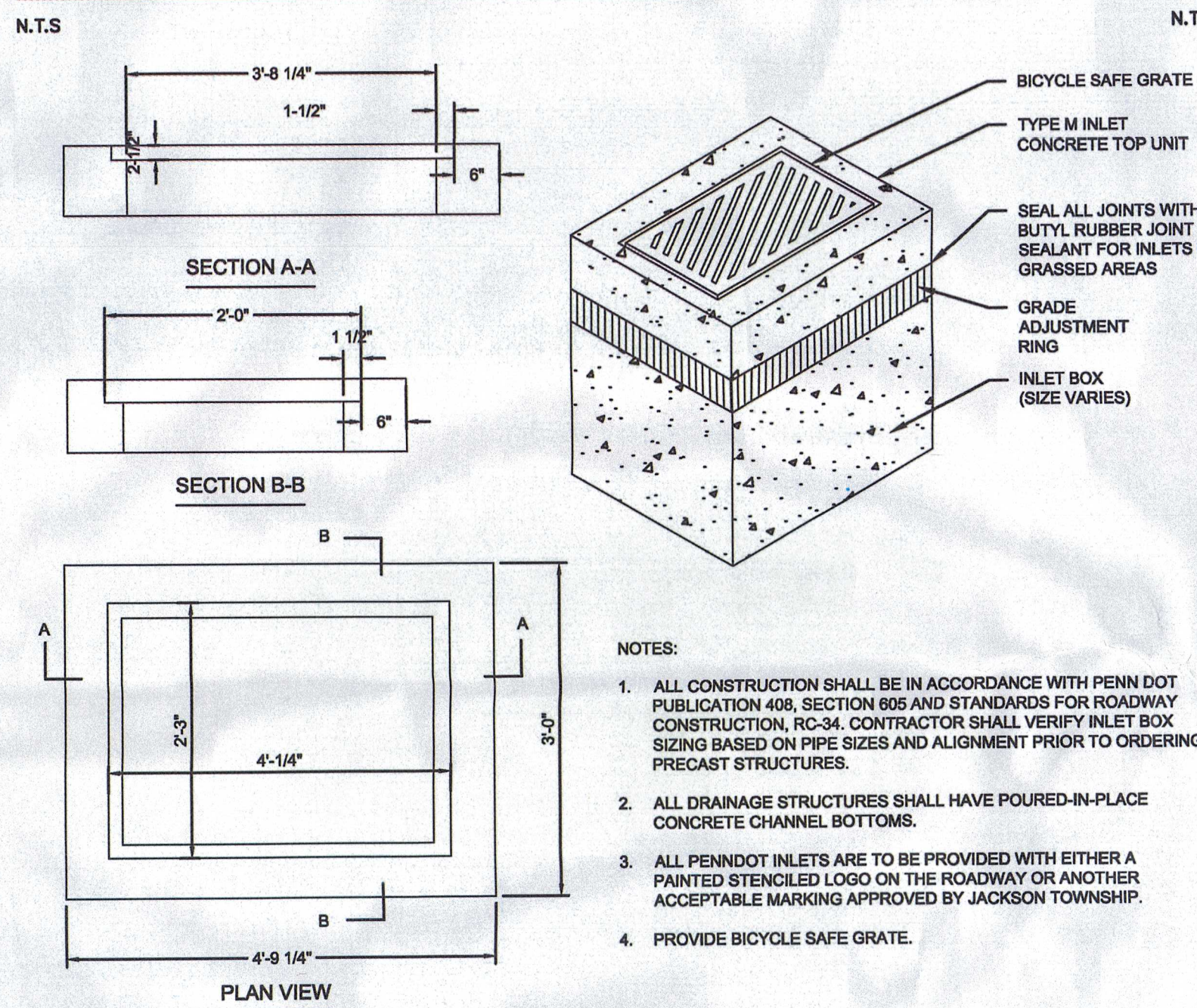

TYPE "M" INLET

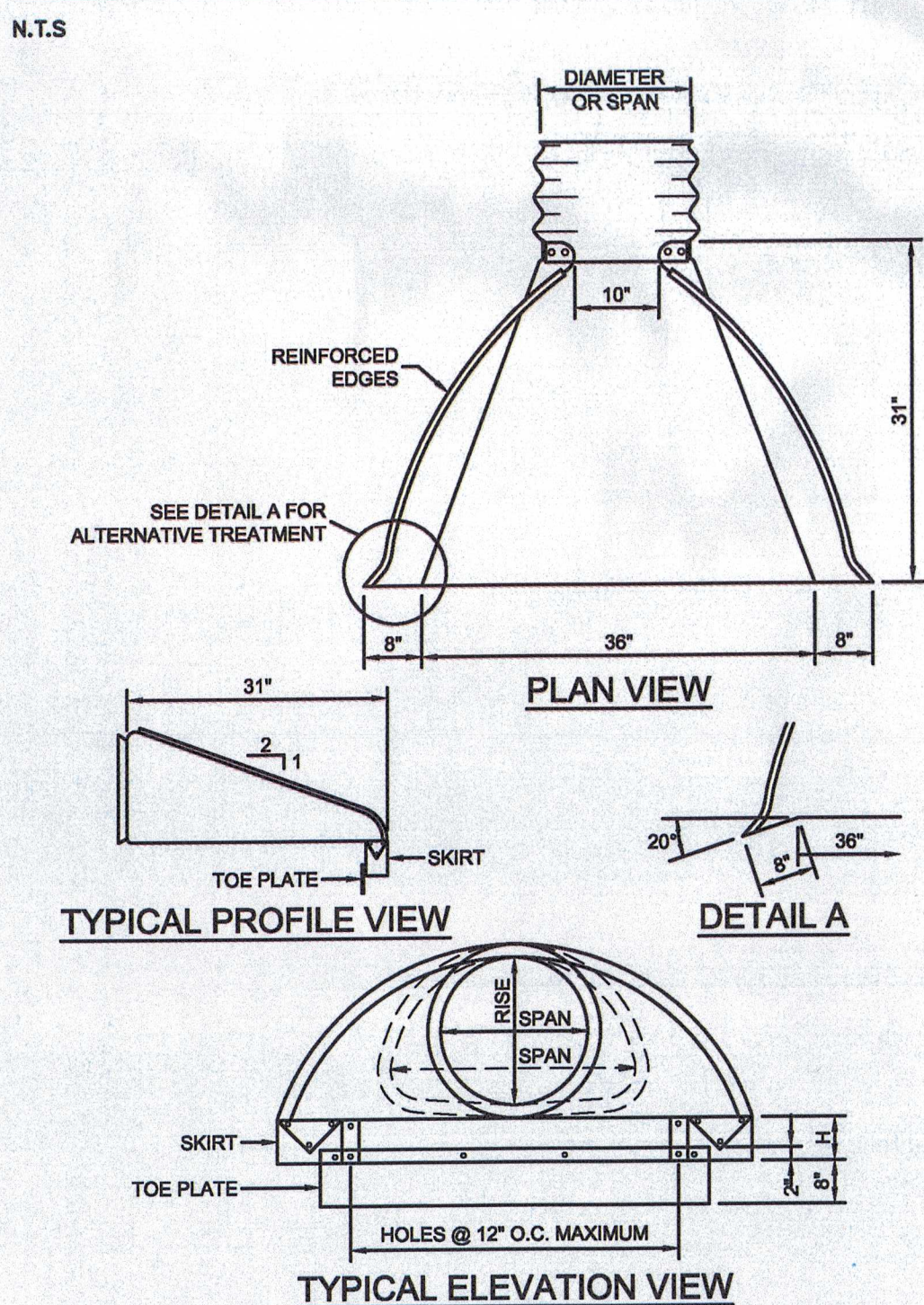

FLARED END SECTION

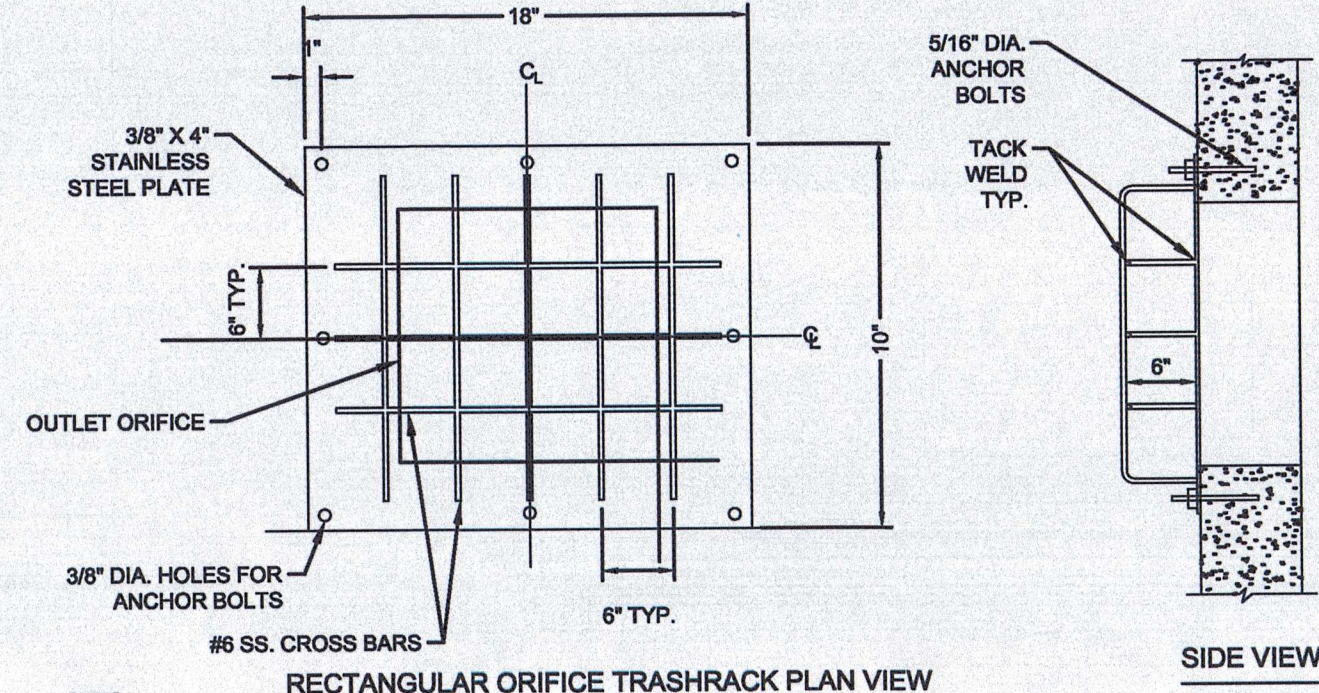

- NOTES:
1. TRASH RACK MATERIAL TO BE STAINLESS STEEL.
 2. SECURE THE TRASHRACK PLATE TO THE SIDE OF THE INLET BOX USING 5/16\"/>

BASIN #2 TRASH RACK FOR RECTANGULAR OUTLET STRUCTURE OS-8

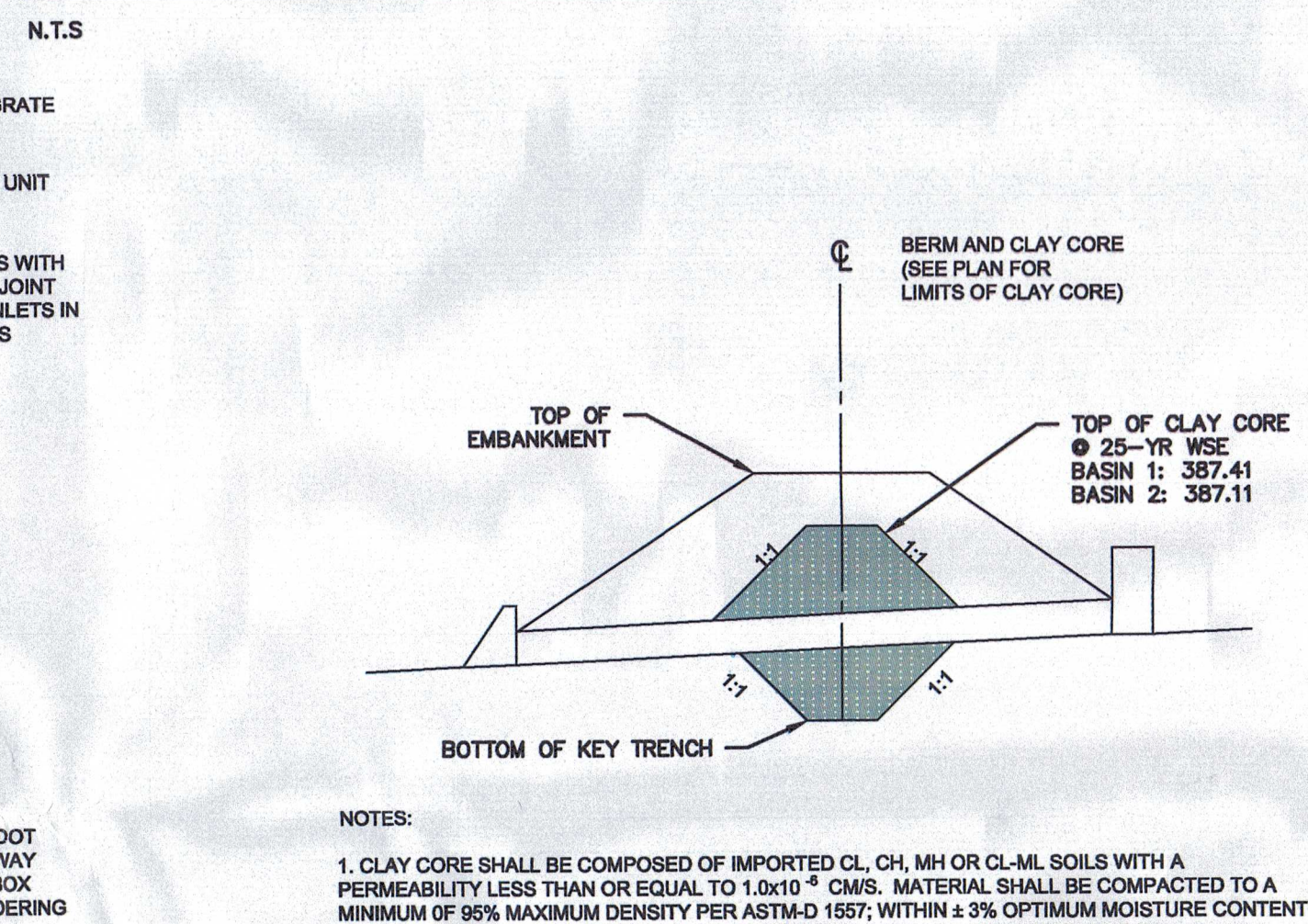

- NOTES:
1. CLAY CORE SHALL BE COMPOSED OF IMPORTED CL, CH, MH OR CL-ML SOILS WITH A PERMEABILITY LESS THAN OR EQUAL TO 1.0x10⁻⁸ CM/S. MATERIAL SHALL BE COMPACTED TO A MINIMUM OF 95% MAXIMUM DENSITY PER ASTM-D 1557; WITHIN ± 3% OPTIMUM MOISTURE CONTENT.

CLAY CORE

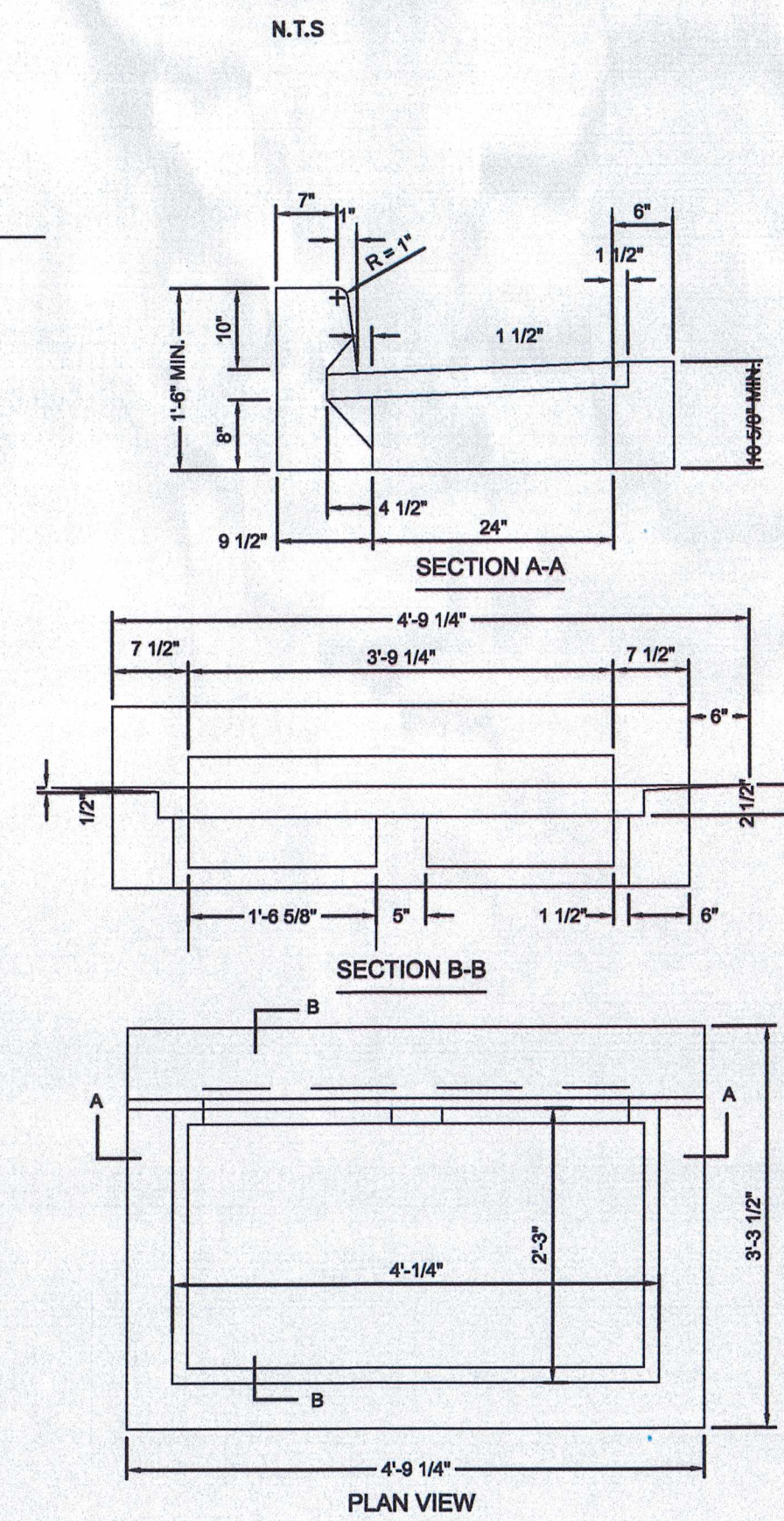

- NOTES:
1. ALL CONSTRUCTION SHALL BE IN ACCORDANCE WITH PENNDOT PUBLICATION 408, SECTION 605 AND STANDARDS FOR ROADWAY CONSTRUCTION, RC-34. CONTRACTOR SHALL VERIFY INLET BOX SIZING BASED ON PIPE SIZES AND ALIGNMENT PRIOR TO ORDERING PRECAST STRUCTURES.
 2. ALL DRAINAGE STRUCTURES SHALL HAVE POURED-IN-PLACE CONCRETE CHANNEL BOTTOMS.
 3. ALL PENNDOT INLETS ARE TO BE PROVIDED WITH EITHER A PAINTED STENCILED LOGO ON THE ROADWAY OR ANOTHER ACCEPTABLE MARKING APPROVED BY THE GOVERNING AGENCY.
- NOTES:
1. INLET TO BE IN CONFORMANCE WITH PA DOT ROADWAY CONSTRUCTION STANDARDS (RC-34) AND CERTIFIED FOR H20 LOADING.
 2. PROVIDE BICYCLE SAFE GRATE.

TYPE "C" INLET

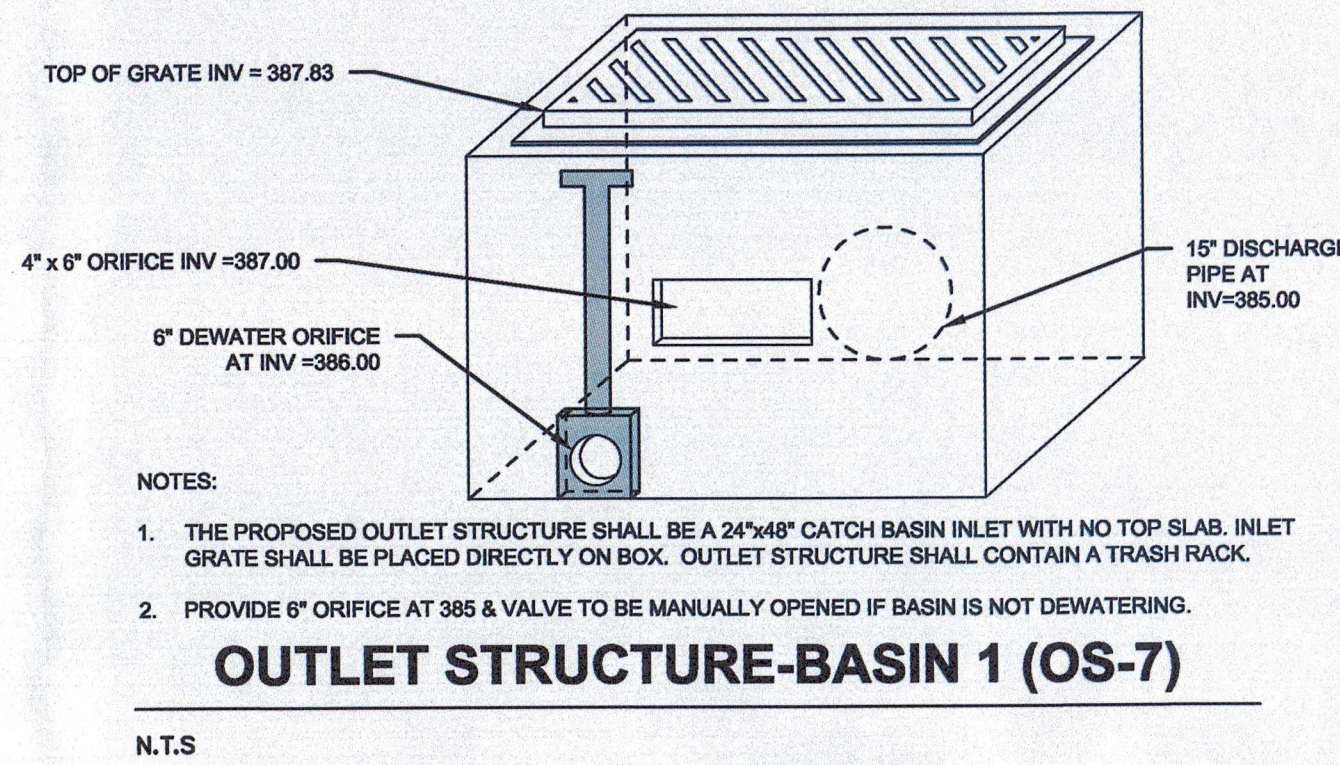

OUTLET STRUCTURE-BASIN 1 (OS-7)

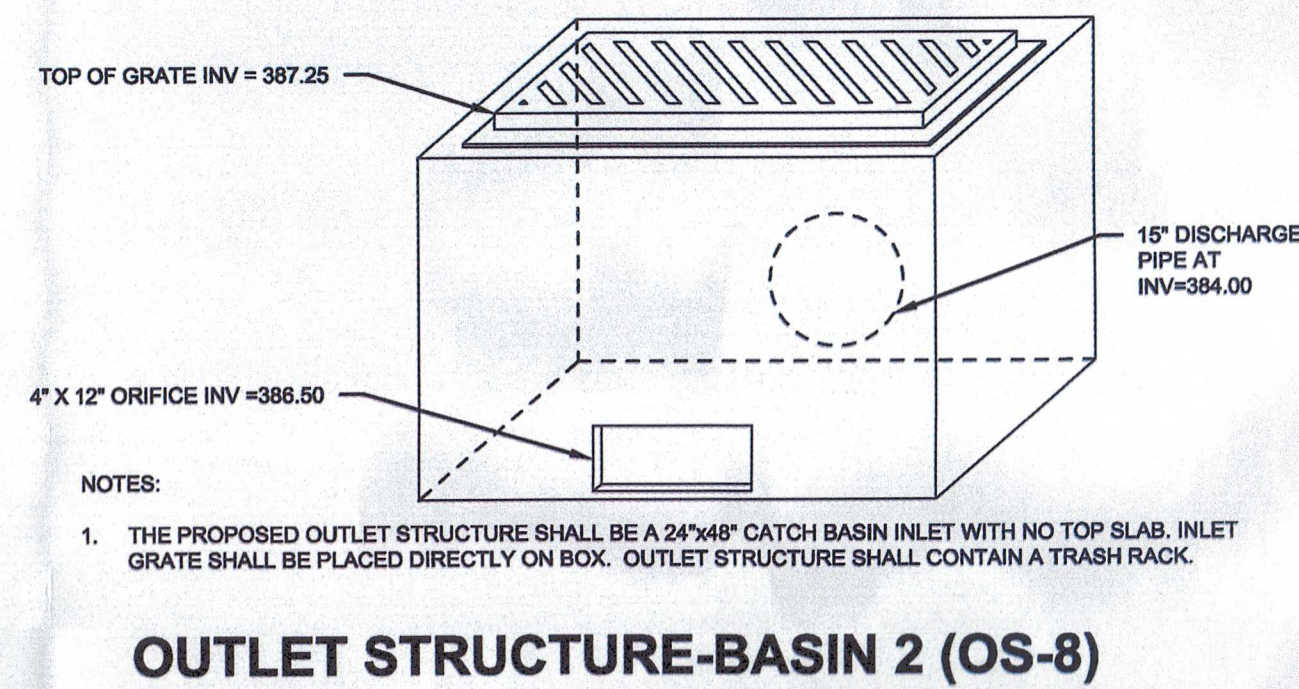

OUTLET STRUCTURE-BASIN 2 (OS-8)

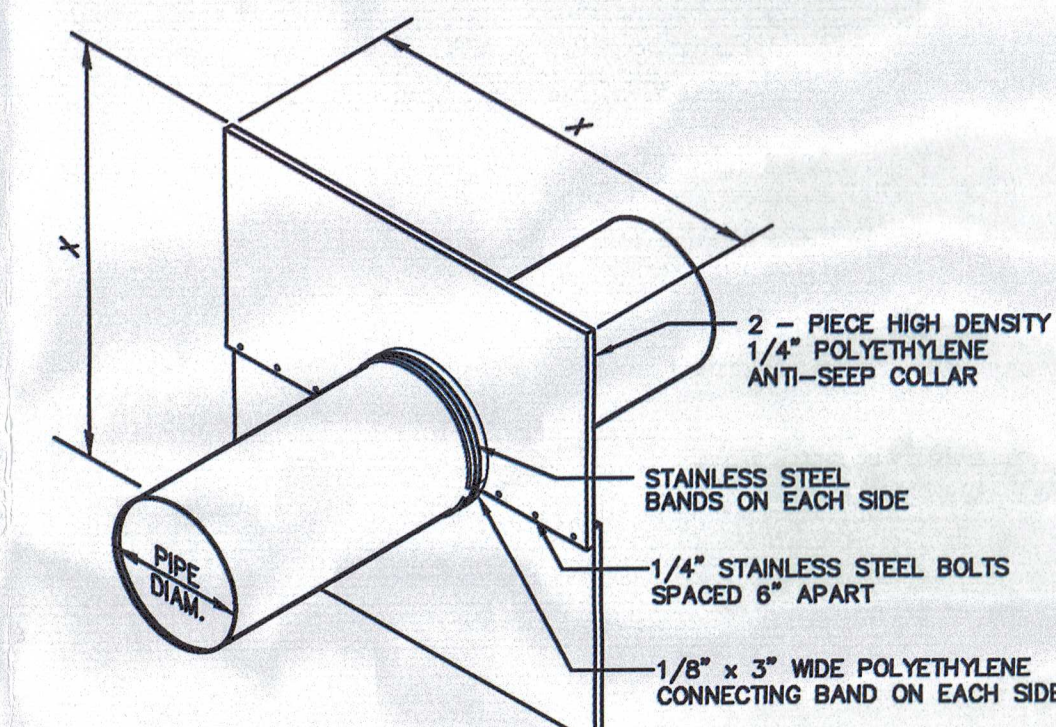

OUTLET PIPE DESIGNATION	NUMBER OF COLLARS	COLLAR SPACING (FT)	X (INCHES)	DISTANCE FROM OUTLET STRUCTURE (FT)
BASIN 1	3	5	34	5
BASIN 2	3	4	29	5

- NOTES:
1. SEE BASIN EMBANKMENT DETAIL FOR LOCATION WITHIN BERM.
 2. APPLY MASTIC TO CONNECTING BANDS AND SET IN PLACE. BOLT HALVES TOGETHER & INSTALL METAL BANDS ON SPLIT HALVES OF COLLAR. TIGHTEN BOLTS AND BANDS. APPLY MASTIC AS NEEDED TO INSURE GOOD SEAL. BACKFILL AND HAND TAMP.
 3. DO NOT LOCATED AN ANTI-SEEP COLLAR CLOSER THAN 2 FEET TO A PIPE JOINT.

HDPE ANTI-SEEP COLLAR DETAIL

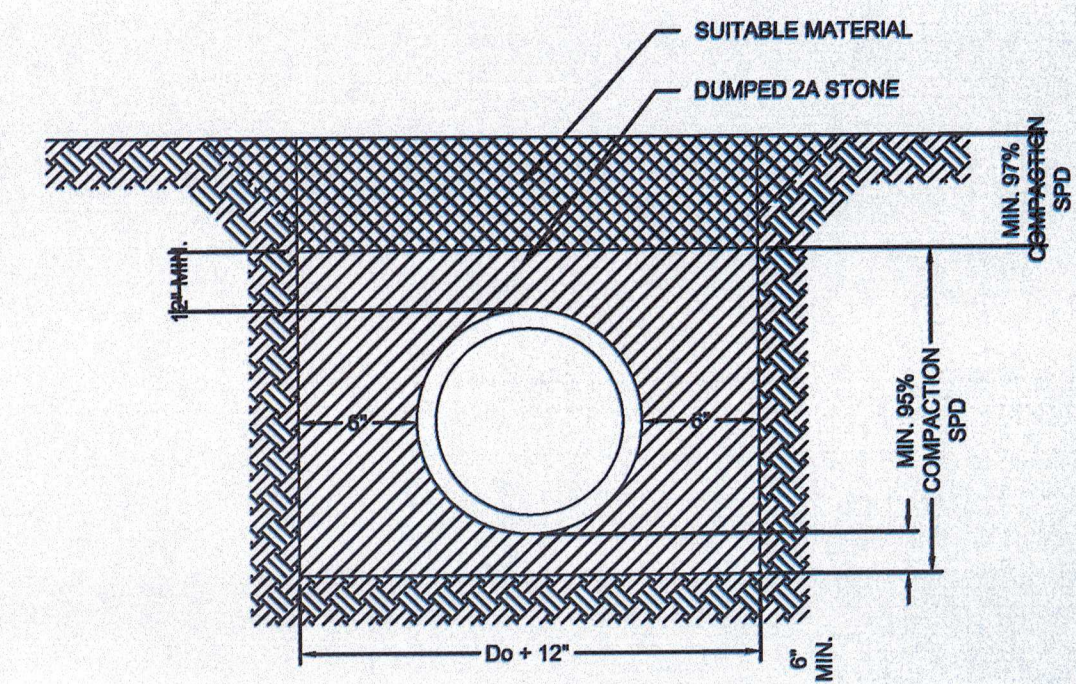
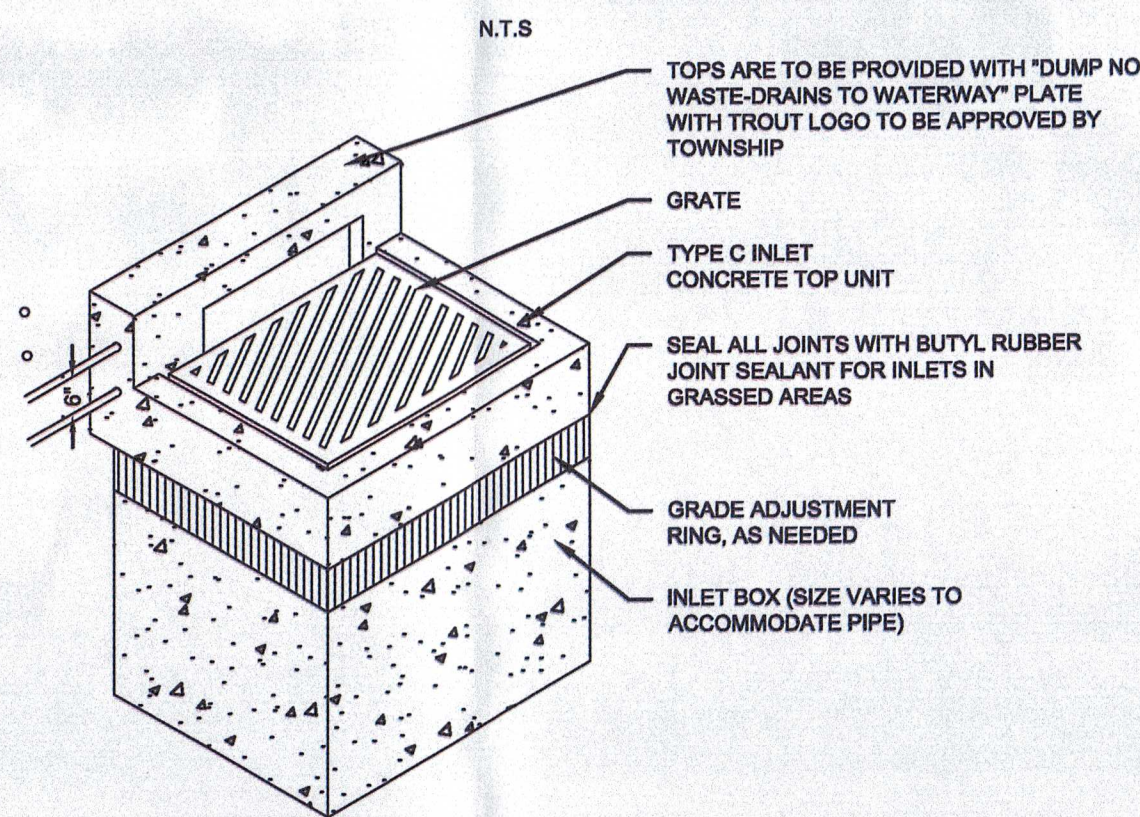

STORM PIPE TRENCH SECTION

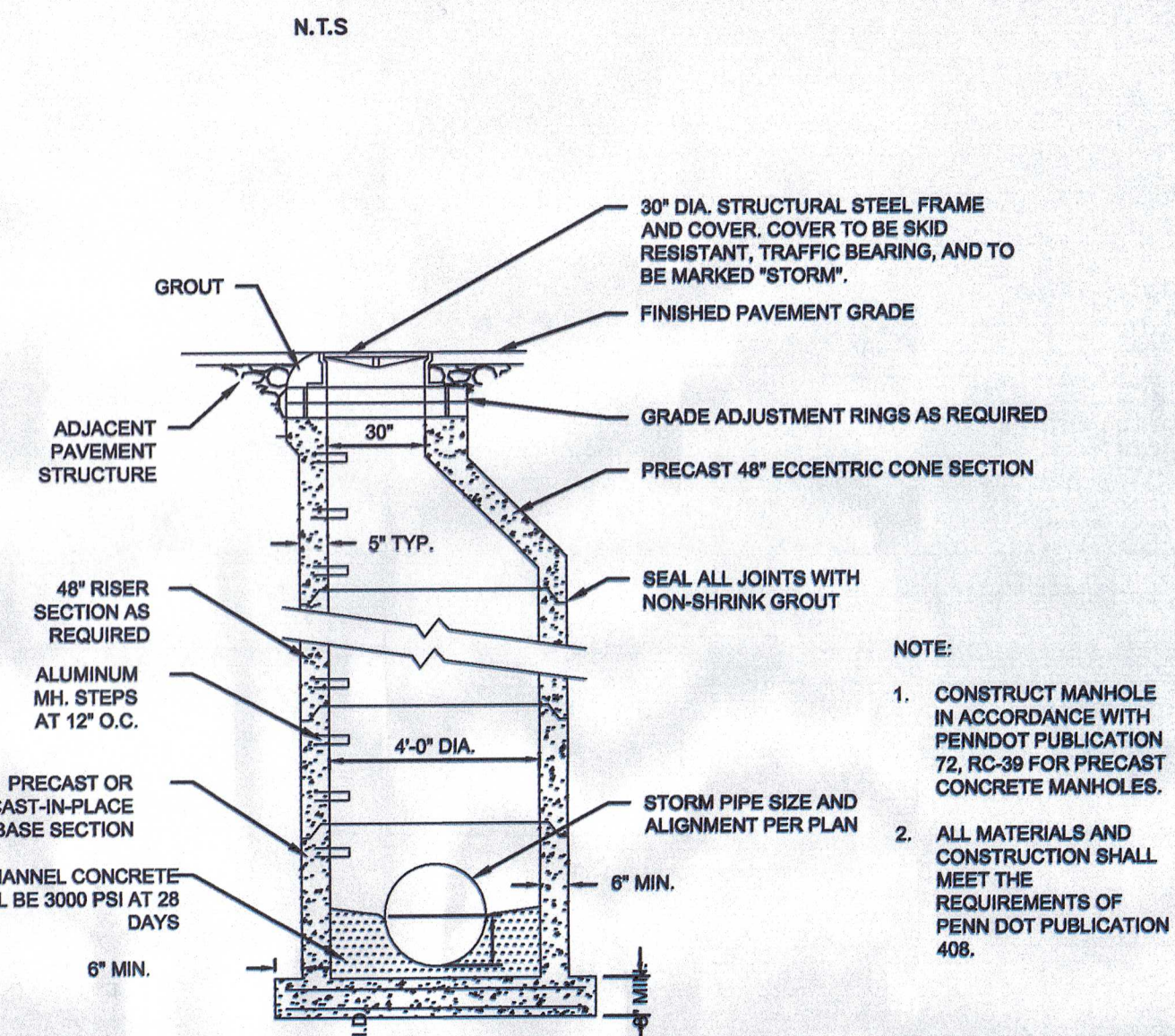

STORM SEWER MANHOLE

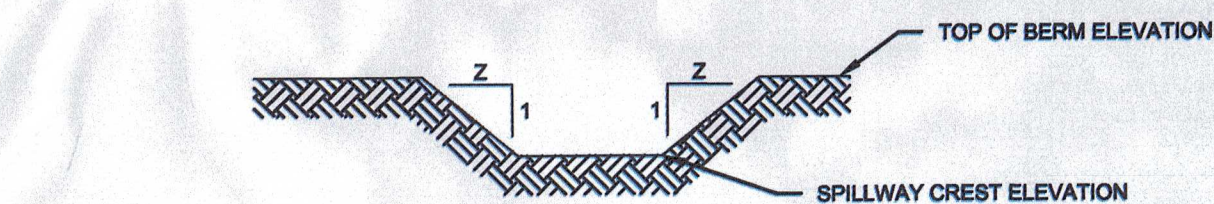

SPILLWAY DESIGNATION	CREST LENGTH (FT)	CREST ELEV. (FT)	TOP OF BERM ELEV. (FT)	Z	SPILLWAY SURFACE LINING
BASIN 1	30	388.20	388.70	3	NAG C350 OR APPROVED EQUAL
BASIN 2	20	387.50	388.00	3	NAG C350 OR APPROVED EQUAL

GRASS-LINED SPILLWAY

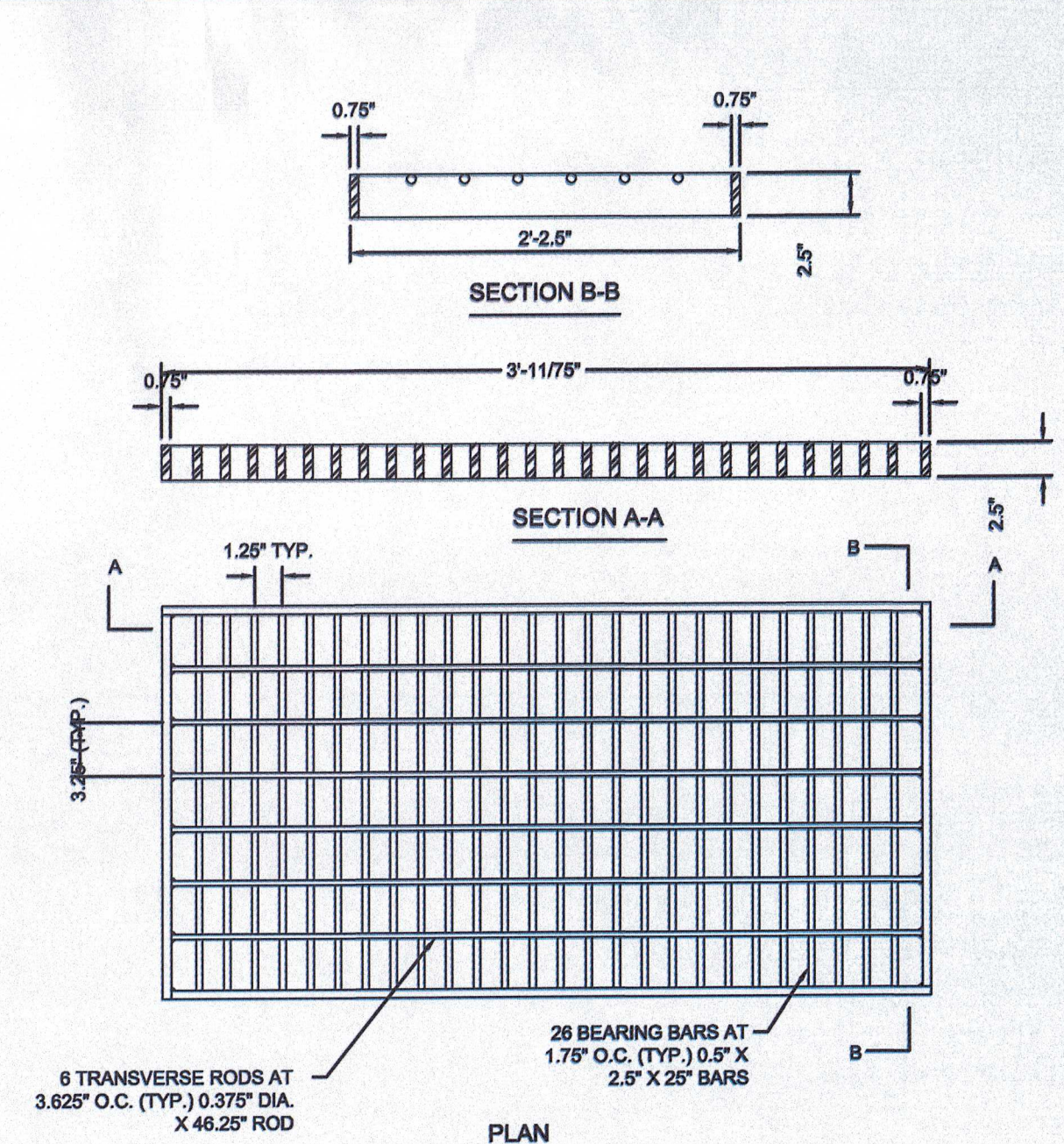

STRUCTURAL STEEL BICYCLE SAFE GRATE

PROFESSIONAL SEAL

DRAWN	TLD
REVIEWED	JLK
SCALE	AS NOTED
DATE	10/11/2022
PROJECT NO.	22-0240
CAD FILE:	06 - DETAILS

REVISIONS	NO.	DATE	DESCRIPTION
1	11/26/2022	REVISED PER GOOD REVIEW COMMENTS	
2	12/27/2022	REVISED PER GOOD TECHNICAL REVIEW COMMENTS	

DETAILS

O&M PROGRAM FOR BMPs

1. THE PURPOSE OF THESE INSTRUCTIONS IS TO IDENTIFY THE OWNERSHIP AND MAINTENANCE ACTIVITIES ASSOCIATED WITH THE PROPOSED RAINGARDEN. THE AFOREMENTIONED FACILITIES SHALL BE THE RESPONSIBILITY OF THE PERMIT APPLICANT (PERMITTEE).
2. ALL PCSM BMPs WILL BE INSPECTED ACCORDING TO THE SCHEDULES LISTED BELOW. A WRITTEN REPORT MUST BE COMPLETED DOCUMENTING EACH INSPECTION AND ANY REPAIR, REPLACEMENT OR MAINTENANCE ACTIVITY.
3. SOIL, TRASH, DEBRIS OR OTHER MATERIALS REMOVED FROM PCSM BMPs SHALL BE REMOVED FROM THE SITE AND RECYCLED OR DISPOSED OF IN ACCORDANCE WITH THE DEPARTMENT'S SOLID WASTE MANAGEMENT REGULATIONS AT 25 PA. CODE 260.1 ET SEQ., 271.1, AND 287.1 ET SEQ. NO WASTES, UNUSED BUILDING MATERIALS OR OTHER MATERIALS SHALL BE BURNED, BURIED, DUMPED, OR DISCHARGED AT THE SITE.
4. ALL DAMAGED OR NON-FUNCTIONAL BMPs SHALL BE REPAIRED IMMEDIATELY. ANY PCSM BMPs THAT CANNOT BE REPAIRED MUST BE REPLACED AS SOON AS PRACTICABLE.
5. THE PERMIT APPLICANT SHALL BE RESPONSIBLE FOR THE MAINTENANCE OF PERMANENT STORMWATER FACILITIES LOCATED ON THE SUBJECT PROPERTIES. PERMANENT MAINTENANCE OF THE STORM SYSTEM AFTER ACCEPTANCE WILL PRIMARILY CONSIST OF ROUTINE CLEANING OF ACCUMULATED SEDIMENT AND DEBRIS BY FACILITY STAFF OR PRIVATE CONTRACTORS. THE SPECIFIC MAINTENANCE STEPS AND SCHEDULE ARE LISTED BELOW:
6. AT A MINIMUM, ALL BEST MANAGEMENT PRACTICES (BMPs) SHALL BE INSPECTED BY THE LAND OWNER/DEVELOPER OR RESPONSIBLE ENTITY ANNUALLY FOR THE FIRST 5 YEARS, ONCE EVERY 3 YEARS THEREAFTER, AND DURING OR IMMEDIATELY AFTER THE CESSATION OF A 100-YEAR OR GREATER STORM EVENT.

INFILTRATION BASINS	
OPERATION & MAINTENANCE PROCEDURES	
ACTIVITY	SCHEDULE
OVER-EXCAVATE INTO BEDROCK TO DESIRED INFILTRATION BASIN BOTTOM ELEVATION, AND PER GEOTECHNICAL ENGINEERING REPORT. INSTALL GEOTEXTILE, STONE AND SAND/SOIL MIX PER THE GEOTECHNICAL ENGINEER RECOMMENDATIONS AND APPROVED PLANS. SEED WITH PLANTING MIX AS SHOWN ON APPROVED PLANS. QUALIFIED PROFESSIONAL OR THEIR DESIGNEE SHALL ENSURE THAT DESIGN INFILTRATION RATE OF 1.0 INCH/HOUR IS BEING.	AT CONVERSION OF E&S TRAPS TO PERMANENT PCSM INFILTRATION BASINS
FIRST GROWING SEASON: WHENEVER VEGETATION REACHES A HEIGHT OF 18-24". TRIM TO A HEIGHT OF 8". HAND PULL PROBLEM WEEDS. SECOND GROWING SEASON: PRIOR TO NEW SPRING GROWTH REACHING A HEIGHT OF 2", TRIM ALL VEGETATION DOWN TO 2". HAND PULL PROBLEM WEEDS.	FIRST AND SECOND GROWING SEASONS AND ONCE PER YEAR AFTER LAST FREEZE IN APRIL
REMOVE LITTER AND DEBRIS	MONTHLY
INSPECT FOR SEDIMENT BUILDUP, EROSION, AND VEGETATIVE CONDITIONS. STABILIZE ERODED BANKS, REPAIR UNDERCUT AND ERODED AREAS AT INFLOW AND OUTFLOW STRUCTURES, AND RESEED AS NECESSARY TO ENSURE STABILIZATION. CONTACT QUALIFIED PROFESSIONAL IF SIGNIFICANT SEDIMENT BUILDUP (I.E. POND VOLUME HAS BEEN REDUCED BY 10%) OR EROSION HAS OCCURRED.	ONCE PER YEAR BETWEEN MARCH 31 AND MAY 31 AND AFTER A STORM EVENT
INSPECT FACILITY FOR SIGNS OF WETNESS OR DAMAGE TO STRUCTURES. NOTE ERODED AREAS. IF DEAD OR DYING GRASS ON THE BOTTOM IS OBSERVED, CHECK TO ENSURE THAT WATER IS PERCOLATING WITHIN THE DESIGN DEWATERING TIME OF 1.0 INCH/HOUR.	ONCE PER YEAR BETWEEN MARCH 31 AND MAY 31 AND AFTER A STORM EVENT 0.25 INCHES OR GREATER
GENERAL MAINTENANCE NOTES: 1. VEGETATION ALONG THE SURFACE OF THE INFILTRATION BASINS SHOULD BE MAINTAINED IN GOOD CONDITION, AND ANY BARE SPOTS REVEGETATED AS SOON AS POSSIBLE. 2. VEHICLES SHOULD NOT BE PARKED OR DRIVEN ON BASINS, AVOID COMPACTION. 3. WHILE VEGETATION IS BEING ESTABLISHED, PRUNING AND WEEDING MAY BE REQUIRED. 4. DURING PERIODS OF EXTENDED DROUGHT, INFILTRATION AREAS MAY REQUIRE WATERING.	
POTENTIAL FAILURES: 1. THE BASINS DO NOT DEWATER - A GATE VALVE HAS BEEN PROVIDED TO DEWATER MANUALLY. THIS VALVE SHALL ONLY BE OPENED TO PERFORM MAINTENANCE ON THE BASIN. CONTACT ENGINEER OF RECORD TO DETERMINE CAUSE AND SOLUTION. 2. BERM DEGRADATION / BREACH - RESTORE BERM TO DESIGN ELEVATIONS USING SUITABLE MATERIAL IN 8" LIFTS. APPLY MATTING AND RESEED IMMEDIATELY. 3. BARE SPOTS - RESEED AREAS WITH SPECIFIED SEED MIX.	

STORMWATER COLLECTION/CONVEYANCE	
OPERATION & MAINTENANCE PROCEDURES	
ACTIVITY	SCHEDULE
INLETS & CATCH BASINS SHOULD BE CLEANED OF DEBRIS. REPAIRS SHOULD BE MADE AS SOON AS PROBLEMS ARISE.	CLEAN ONCE PER YEAR & REPAIR AS NEEDED
INSPECT OUTFALL STRUCTURES QUARTERLY DURING 1ST YEAR & 1X PER YEAR THEREAFTER	QUARTERLY & ONCE PER YEAR
COLLECTION/CONVEYANCE SYSTEMS SHOULD BE INSPECTED 2X PER YEAR MINIMUM.	TWICE PER YEAR
GENERAL MAINTENANCE NOTES: 1. VACUUM TRUCKS MAY BE AN EFFICIENT CLEANING MECHANISM. 2. CATCH BASINS SHOULD BE CLEANED BEFORE HALF FULL.	

DRY EXTENDED DETENTION BASIN	
OPERATION & MAINTENANCE PROCEDURES	
ACTIVITY	SCHEDULE
REPAIR UNDERCUT OR ERODED AREAS, MOW SIDE SLOPES, SEED OR SOD TO REPAIR DEAD OR DAMAGED GROUND COVER.	AS NEEDED
ALL BASIN STRUCTURES EXPECTED TO RECEIVE &/OR TRAP DEBRIS & SEDIMENT SHOULD BE INSPECTED FOR CLOGGING & EXCESSIVE DEBRIS & SEDIMENT ACCUMULATION, AS WELL AS AFTER EVERY STORM GREATER THAN 1 INCH.	FOUR TIMES PER YEAR
NOTE EROSION OF POND BANKS OR BOTTOM.	SEMI-ANNUAL
INSPECT FOR DAMAGE TO THE EMBANKMENT. MONITOR FOR SEDIMENT ACCUMULATION IN THE FACILITY & FOREBAY, EXAMINE TO ENSURE THAT INLET & OUTLET DEVICES ARE FREE OF DEBRIS & OPERATIONAL. INSPECT VEGETATED AREAS FOR EROSION & INVASIVE SPECIES.	ANNUAL
REMOVE SEDIMENT FROM THE FOREBAY (IF APPLICABLE).	5-7 YEAR MAINTENANCE
MONITOR SEDIMENT ACCUMULATIONS, & REMOVE SEDIMENT WHEN THE POND VOLUME HAS BEEN REDUCED BY 25%.	25-50 YEAR MAINTENANCE
GENERAL MAINTENANCE NOTES: 1. SEDIMENT REMOVAL SHOULD BE CONDUCTED WHEN THE BASIN IS COMPLETELY DRY. 2. VEGETATIVE COVER SHOULD BE MAINTAINED AT A MINIMUM OF 85%. 3. IF VEGETATIVE COVER HAS BEEN REDUCED BY 10%, VEGETATION SHOULD BE REESTABLISHED.	

VEGETATED SWALE	
OPERATION & MAINTENANCE PROCEDURES	
ACTIVITY	SCHEDULE
MOW GRASS TO MAINTAIN A HEIGHT OF 3-4 INCHES. ROTOTILL OR CULTIVATE THE SURFACE OF THE SAND/SOIL BED OF DRY SWALES IF THE SWALE DOES NOT DRAW DOWN WITHIN 48 HOURS. REMOVE SEDIMENT BUILD-UP WITHIN THE BOTTOM OF THE SWALE ONCE IT HAS ACCUMULATED TO 25% OF THE ORIGINAL DESIGN VOLUME, OR ONCE IT HAS COVERED VEGETATION.	AS NEEDED
INSPECT PEA GRAVEL DIAPHRAGM FOR CLOGGING & CORRECT THE PROBLEM. INSPECT GRASS ALONG SIDE SLOPES FOR EROSION, RILLS, OR GULLIES, & CORRECT. REMOVE TRASH & DEBRIS ACCUMULATED IN SWALE. INSPECT & CORRECT EROSION PROBLEMS IN THE BED OF DRY SWALES. INSPECT VEGETATION, PLANT ALTERNATIVE SPECIES IF ORIGINAL SPECIES HAVE NOT SUCCESSFULLY ESTABLISHED. INSPECT FOR POOLS OF STANDING WATER, DEWATER & DISCHARGE TO AN APPROVED LOCATION, RESTORE TO DESIGN GRADE. INSPECT FOR UNIFORMITY IN CROSS-SECTION & LONGITUDINAL SLOPE, CORRECT AS NEEDED.	ANNUAL
INSPECT SWALE IMMEDIATELY AFTER SPRING MELT. REMOVE RESIDUALS AND REPLACE DAMAGED VEGETATION. IF ROADSIDE OR PARKING LOT RUNOFF IS DIRECTED TO THE SWALE, MULCHING &/OR SOIL AERATION MAY BE REQUIRED IN THE SPRING TO RESTORE SOIL STRUCTURE & MOISTURE CAPACITY & TO REDUCE THE IMPACT OF DEICING AGENTS. USE NONTOXIC, ORGANIC DEICING AGENTS. PLANT SALT TOLERANT VEGETATION IN SWALES.	ONCE PER YEAR APRIL

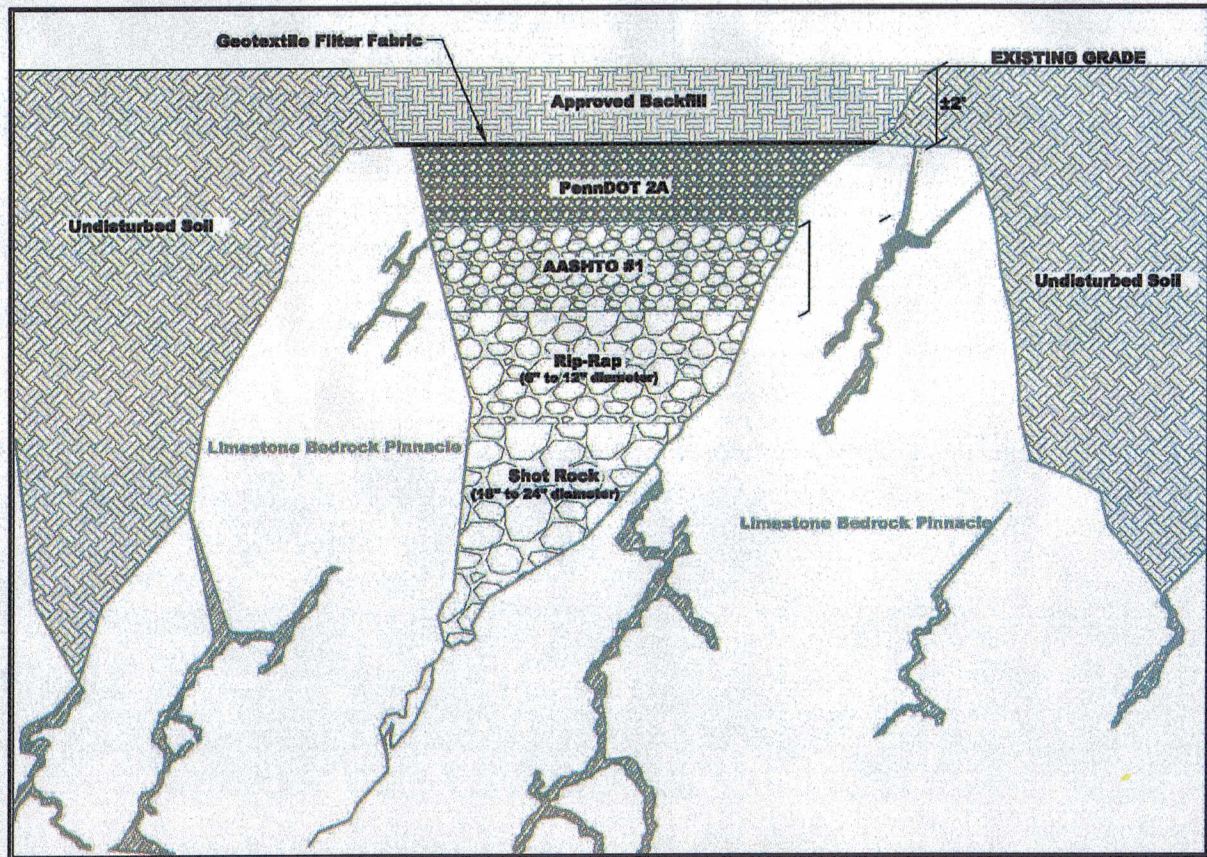

SINKHOLE REPAIR DETAIL

N.T.S.

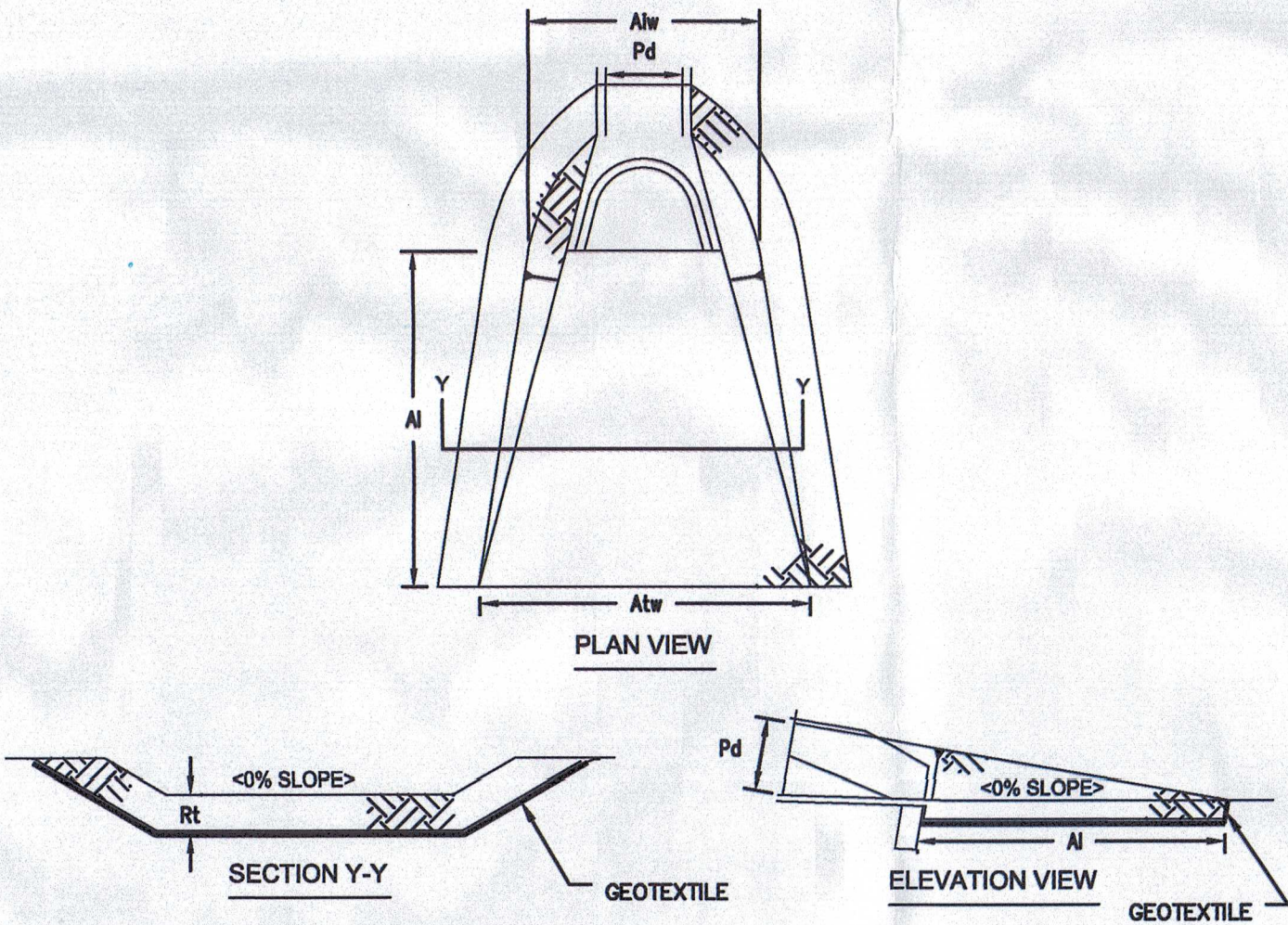

OUTLET NO.	PIPE DIA Pd (IN)	RIPRAP		APRON		
		SIZE (R-)	THICK. Rt (IN)	LENGTH Al (FT)	INITIAL WIDTH Alw (FT)	TERMINAL WIDTH Atw (FT)
FES-3	15	4	18	9	3.75	12.75
FES-5	18	4	18	9	4.50	13.5

ALL APRONS SHALL BE CONSTRUCTED TO THE DIMENSIONS SHOWN. TERMINAL WIDTHS SHALL BE ADJUSTED AS NECESSARY TO MATCH RECEIVING CHANNELS.

ALL APRONS SHALL BE INSPECTED AT LEAST WEEKLY AND AFTER EACH RUNOFF EVENT. DISPLACED RIPRAP WITHIN THE APRON SHALL BE REPLACED IMMEDIATELY.

RIPRAP APRON AT PIPE OUTLET WITH FLARED ENWALL

N.T.S.

PADEP #8-1

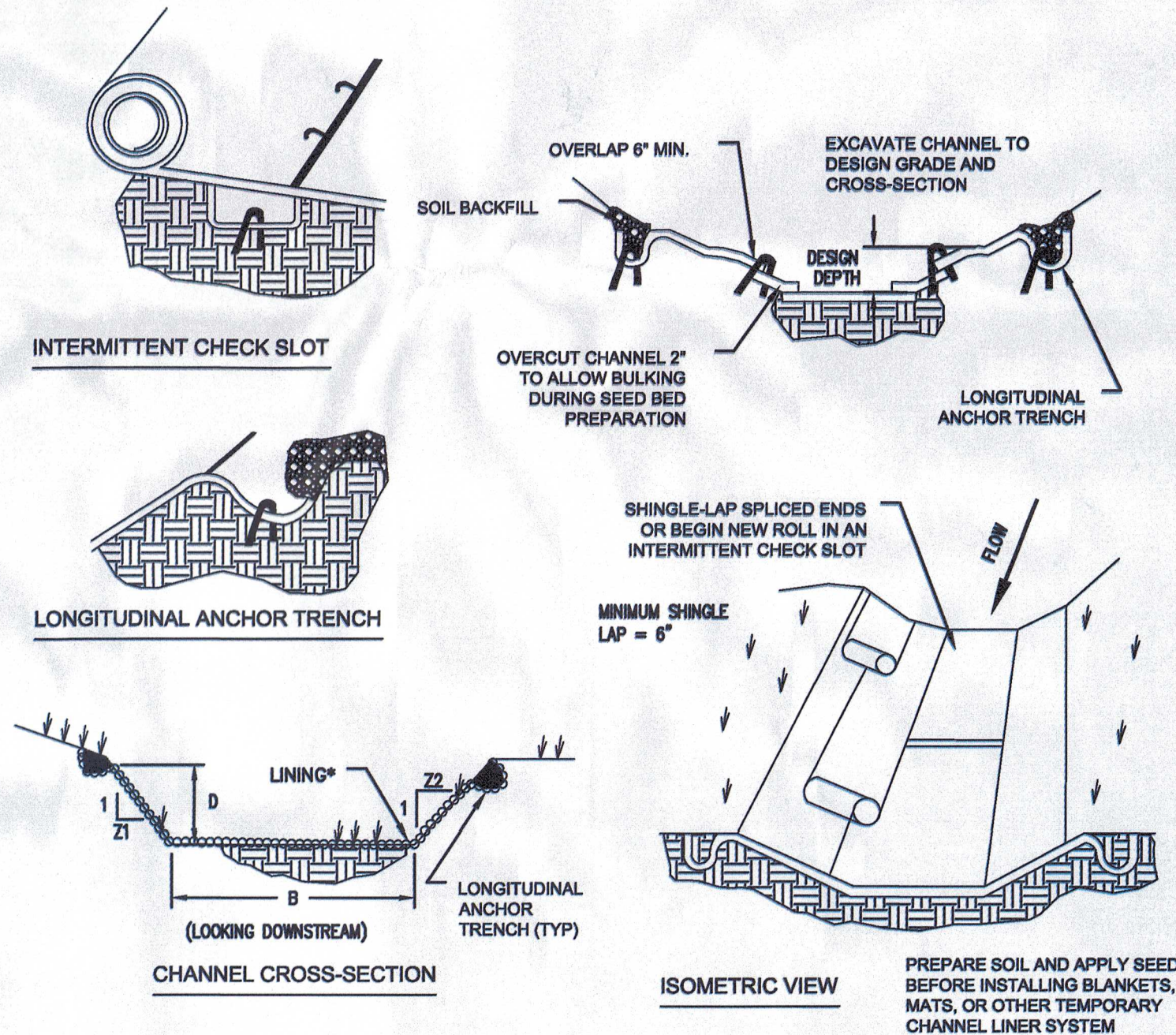

* SEE MANUFACTURER'S LINING INSTALLATION DETAIL FOR STAPLE PATTERNS, AND VEGETATIVE STABILIZATION SPECIFICATIONS FOR SOIL AMENDMENTS, SEED MIXTURES AND MULCHING INFORMATION.

CHANNEL NO.	STATIONS	BOTTOM WIDTH B (FT)	DEPTH D (FT)	TOP WIDTH W (FT)	Z1 (FT)	Z2 (FT)	LINING*
SWALE 1	ALL	5	1	9	2	2	H&G S75 OR APPROVED EQUAL

ANCHOR TRENCHES SHALL BE INSTALLED AT BEGINNING AND END OF CHANNEL IN THE SAME MANNER AS LONGITUDINAL ANCHOR TRENCHES.

CHANNEL DIMENSIONS SHALL BE CONSTANTLY MAINTAINED. CHANNEL SHALL BE CLEANED WHENEVER TOTAL CHANNEL DEPTH IS REDUCED BY 25% AT ANY LOCATION. SEDIMENT DEPOSITS SHALL BE REMOVED WITHIN 24 HOURS OF DISCOVERY OR AS SOON AS SOIL CONDITIONS PERMIT ACCESS TO CHANNEL WITHOUT FURTHER DAMAGE. DAMAGED LINING SHALL BE REPAIRED OR REPLACED WITHIN 48 HOURS OF DISCOVERY.

NO MORE THAN ONE THIRD OF THE SHOOT (GRASS LEAF) SHALL BE REMOVED IN ANY MOWING. GRASS HEIGHT SHALL BE MAINTAINED BETWEEN 2 AND 3 INCHES UNLESS OTHERWISE SPECIFIED. EXCESS VEGETATION SHALL BE REMOVED FROM PERMANENT CHANNELS TO ENSURE SUFFICIENT CHANNEL CAPACITY.

VEGETATED CHANNEL

N.T.S.

PADEP #8-1

PROFESSIONAL SEAL	
DRAWN	TLD
REVIEWED	JLK
SCALE	AS NOTED
DATE	10/11/2022
PROJECT NO.	22-0240
CAD FILE:	08 - DETAILS

REVISIONS	DATE	DESCRIPTION
NO.		
1	11/29/2022	REVISED PER COOD REVIEW COMMENTS
2	12/27/2022	REVISED PER COOD TECHNICAL REVIEW COMMENTS